

SUBMITTAL SHEET

JOB NAME		ITEM TAG	
JOB LOCATION		PART NUMBER	
CONTRACTOR	DATE		
ENGINEER APPROVAL	DATE		

BLUE TOP GAS BALL VALVE

T-3100

Patented one-piece forged brass body eliminates the possibility of seam leaks common to two-piece body designs*

Equipped with an integral 1/8" NPT tapped manometer test port and plug, eliminating the need for a separate test port fitting and shutoff valve near the appliance pilot assembly

Ideal for all residential and commercial gas installations

Chrome plated ball and soft seats resist contamination build-up and offer a positive seal in low- or moderate-pressure gas applications

Quarter-turn, ball-type, forged brass design is more compact and superior to traditional cast bronze or cast iron gas cocks

The 175 p.s.i. pressure rating permits high-pressure air tests, without the grease-seal blowout common to plug-type gas cocks

Available in two different configurations, to accommodate all test-port installation requirements

Working Pressure, Non-Shock (PSI)

Cold working pressure (CWP): 175 psi

Saturated steam (WSP): Not suitable for steam service

- CSA Certified for use with natural, manufactured or mixed liquified petroleum and LP gas/air mixtures:
 - ANSI standard Z21.15 for use as a gas appliance connector valve for 1/2-lb. systems
 - CSA Certified 3-88 for use in 2 or 5 lb. house piping systems
- Threaded end connections conform to ANSI/ASME B1.20.1
- Manufactured in an ISO 9002 accredited facility



- UL listed 44R8 for the sizes 1/2" and 3/4" within the following categories**
 - YQNZ.MH19347 Compressed Gas Shutoff Valves
 - YRBX.MH19347 Flammable Liquid Shutoff Valves
 - YRPV.MH19347 Gas Shutoff Valves
 - MHKZ.MH19347 Manual Valves

**Reprinted from the Online Certifications Directory with permission from Underwriters Laboratories, Inc. Copyright © 2010 Underwriters Laboratories, Inc. ®



MATERIAL SPECIFICATION		
PART	MATERIAL	SPECIFICATION
1 Body	Forged brass	ASTM B124 UNS C37700
2 Seats (2)	Nitrile (NBR) rubber	Type 7PB496 ASTM D2000
3 Ball	Forged brass, chrome plated	ASTM B124 UNS C37700
4 Thrust washer	Synthetic fiber	Commercial grade
5 Stem	Forged brass	ASTM B124 UNS C37700
6 Stem retainer bushing	Forged brass	ASTM B124 UNS C37700
7 Stem O-ring	Nitrile (NBR) rubber	Type 7PB496 ASTM D2000
8 Stem retainer clip	Phosphor-bronze wire	ASTM B159
9 Handle	Coated aluminum	Commercial grade, die-cast
10 Handle screw	Zinc plated steel	ANSI/ASME B18.2.1 IFI C18
11 Test port plug	Forged brass	ASTM B124 UNS C37700

DIMENSIONS					
Size	A	B	C	D	E
1/2" FIP x FIP	2.43	1.84	0.40	2.02	1.57
3/4" FIP x FIP	2.68	2.13	0.60	2.09	1.79
1" FIP x FIP	3.13	2.72	0.84	3.71	2.08
3/8" flare x flare	2.98	1.77	0.28	2.02	1.44
1/2" flare x flare	2.91	1.77	0.40	2.02	1.46

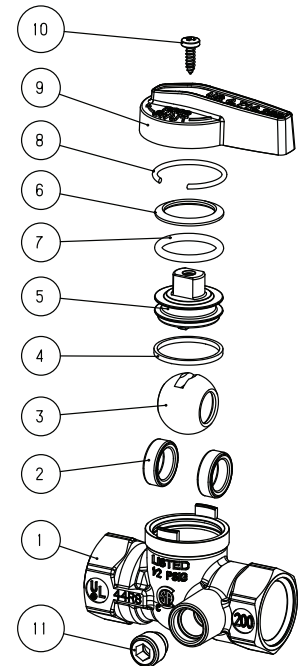
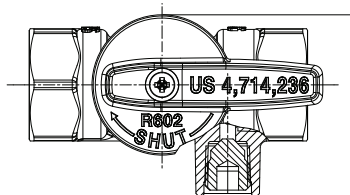
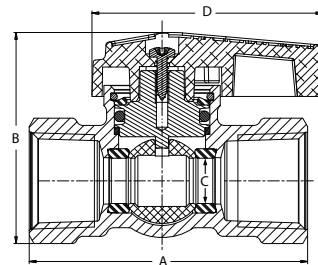

Pictured T-3100
Cut-away and exploded views

*Note: part number 102-522 3/8" flare x flare is a two-piece body design. A flared connection is not subject to the high assembly torque common to pipe-threaded connections, thereby greatly reducing the chance of body seam seal failure and subsequent leakage.