

BISMAT® 2000

for metal pipes \varnothing 2 1/2 - 4"

3/8"

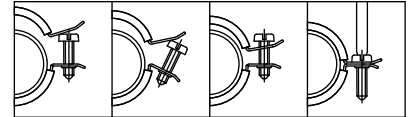

Features and benefits

- two-screw clamp
- with BISMAT® quick locking system
- material: steel
- zinc plated
- sound insulating lining according DIN 4109
- noise insulating lining, EPDM rubber, black
- age resistant lining
- complies with Federal Specification WW-H-w171E and A-A-1192A Type 4 and Manufacturers Standardization Society MSS SP-58 and SP-69 type 12
- Plenum rated - tested to ASTM E-84

Part No.	D (mm)	IP (")	CT (")	G (")	B (")	H (")	h (")	b x s (mm)	Fa,z (lbs)	Pack 1
CR 340 9 070	64 - 70	-	2 1/2	3/8"	4.5	3.9	2.2	23 x 2.0	210	50
CR 340 9 080	73 - 80	2 1/2	3	3/8"	5.0	4.3	2.4	23 x 2.0	210	50
CR 340 9 091	83 - 91	3	-	3/8"	5.4	4.8	2.6	25 x 2.5	210	25
CR 340 9 105	100 - 105	-	4	3/8"	6.0	5.3	2.9	25 x 2.5	210	25
CR 340 9 114	108 - 114	4	-	3/8"	6.3	5.7	3.1	25 x 2.5	210	25

The max. allowed load (Fa,z) is calculated using specific statistical methods related to the breaking load, taking into account a deflection to 1,5 mm or 2% of the maximum nominal clamp diameter. These products are provided with the "Pipe fixing quality mark". According to the RAL-GZ 655 requirements, the test results are monitored by an independent test institute.

