

# AG-1200+

## Float Switch System for Metal and Plastic Secondary Pans

The AG-1200+ has all of the features of the 1100+ plus an innovative two-piece clamp design which allows it to be mounted to a metal drain pan (without a lip) or inferior, non-AquaGuard plastic drain pan (with a lip) in 10 seconds or less, without the need for a drain hole in the pan.

### Key Features

- 5 amp high-capacity sensor designed for metal and plastic pans
- The industry leading float switch for metal and plastic drain pans
- Easy, no-drill installation
- Protective housing keeps out insulation and debris
- NEW Open circuit wiring option



### Product Specs

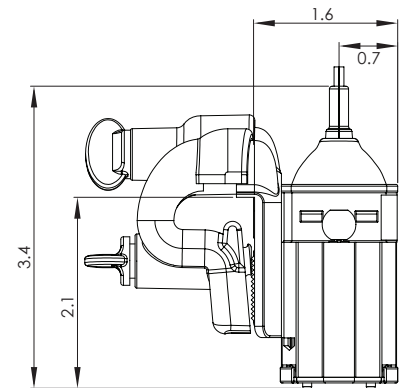
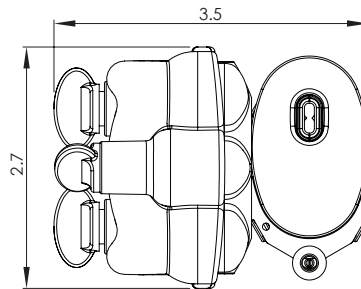
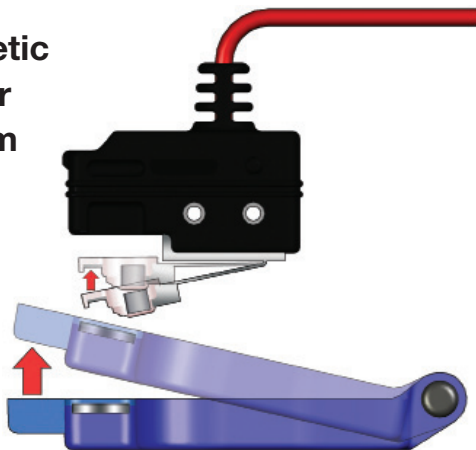

- UL LISTED (UL 508)
- NORMALLY CLOSED OR NORMALLY OPEN
- VERTICAL TRIGGER DEPTH OF 3/4 INCH
- VOLTAGE RATING: 24VAC, 5.0A

### Magnetic Trigger System



# DRAIN PAN SELECTION CHART

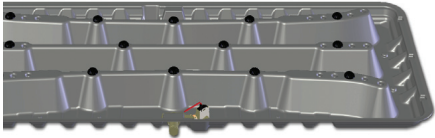
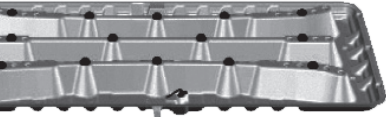
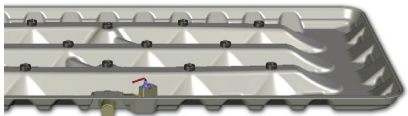
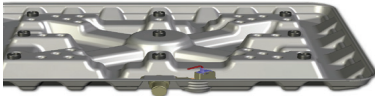
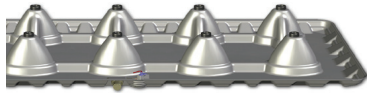
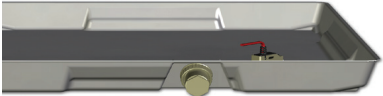

Secondary Pan Model	Pan Size	External Pan Size			Max Unit Size		Recommended Application
<b>Goliath Series</b>							
		<u>Width</u>	<u>Length</u>	<u>Height</u>	<u>Width</u>	<u>Length</u>	<b>Hangable</b> When additional clearance is needed under air handler for drain. General Purpose for both furnace and air handler installation.
	<b>30x50</b>	30.25"	50.50"	4.00"	27.25"	47.50"	
	<b>30x62</b>	30.38"	63.00"	4.25"	27.38"	60.00"	
	<b>28x57</b>	28.38"	57.25"	5.25"	25.38"	54.25"	
	<b>28x69</b>	28.25"	69.13"	4.25"	26.00"	66.50"	
	<b>30x66</b>	30.25"	66.50"	4.00"	27.25"	64.00"	
<b>Goliath Value Series</b>							
		<u>Width</u>	<u>Length</u>	<u>Height</u>	<u>Width</u>	<u>Length</u>	<b>Non-Hangable</b> General purpose for air handler installation.
	<b>30x50</b>	30.25"	50.50"	4.00"	27.25"	47.5"	
	<b>30x62</b>	30.38"	63.00"	4.25"	27.38"	60.00"	
	<b>30x66</b>	30.25"	66.50"	4.00"	27.25"	64.00"	
<b>Goliath Low Profile</b>							
	<b>26x56</b>	26.50"	56.63"	2.75"	23.50"	53.63"	<b>Hangable</b> When space is at a minimum in a garage or attic.
<b>Goliath Furnace Series</b>							
	<b>30x36</b>	30.50"	37.50"	3.00"	27.50"	34.50"	<b>Non-Hangable</b> For Vertical, upflow installation of furnace or air handler.
<b>Goliath Furnace Series</b>							
		<u>Width</u>	<u>Length</u>	<u>Height</u>	<u>Width</u>	<u>Length</u>	<b>Non-Hangable</b> When greater clearance height is needed to accommodate piping under furnace.
	<b>34x64</b>	34.13"	64.13"	7.50"	31.13"	61.13"	
	<b>34x79</b>	33.75"	79.00"	7.50"	30.75"	76.00"	
<b>Titan Flexible Series</b>							
		<u>Width</u>	<u>Length</u>	<u>Height</u>	<u>Width</u>	<u>Length</u>	<b>Non-Hangable</b> Flexible and durable enough to bend and fit into tight spaces.
	<b>24x24</b>	24.00"	24.00"	2.25"	20.00"	20.50"	
	<b>26x26</b>	26.00"	26.00"	2.25"	22.00"	22.50"	
	<b>30x30</b>	30.00"	30.00"	2.25"	26.00"	26.50"	
	<b>32x32</b>	32.00"	32.00"	2.25"	28.00"	28.50"	
<b>Titan Flexible Series</b>							
		<u>Width</u>	<u>Length</u>	<u>Height</u>	<u>Width</u>	<u>Length</u>	<b>Hangable</b> Flexible and durable enough to bend and fit into tight spaces.
	<b>30x50</b>	30.25"	50.50"	2.50"	27.25"	47.50"	
	<b>30x62</b>	30.38"	63.00"	2.50"	27.38"	60.00"	

