

## AHE Series 2 &amp; 3 Blower and Ignition Control Components

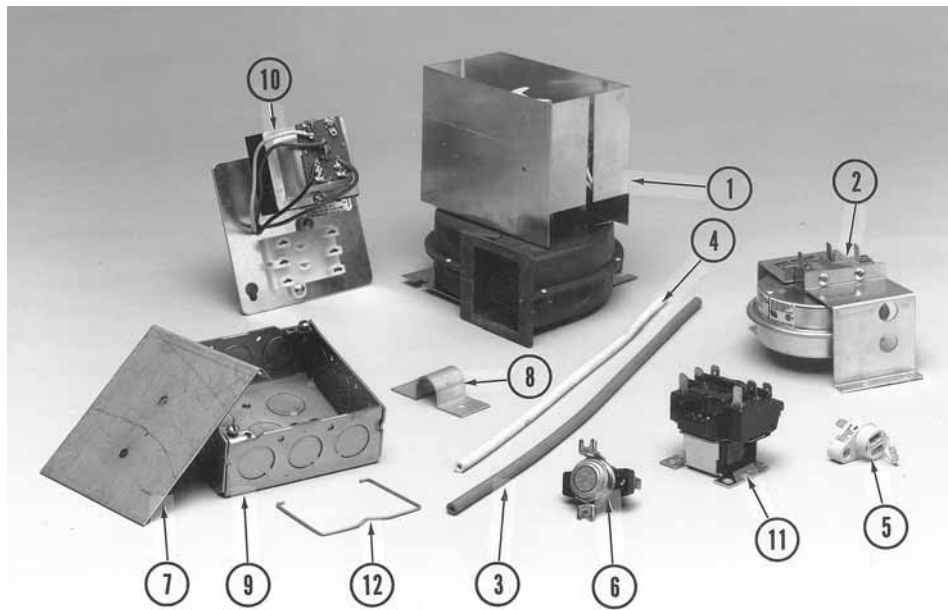

Fig. No.	Part No.	Description	Mfr.	Mfr.'s Part No.	AHE Boiler Size		Notes
					45	60	
1	510-811-466	Blower and Motor Assembly Replacement Kit (Includes Blower Housings Left & Right, Mounting Plate, Blower Wheel, Blower Motor 120/60/1, Motor Fan, Guard), Series 2 & 3	Weil-McLain		X	X	
2	511-624-530	Differential Pressure Switch, SPST Switch Action, 0.35" W.C. Setting, Sea Level to 4,000 ft. Elevation, Series 2 & 3	Tridelta	FS6707-1388	X		
2	511-624-530	Differential Pressure Switch, SPST Switch Action, 0.35" W.C. Setting, Sea Level to 4,000 ft. Elevation, Series 2 & 3	Tridelta	FS4125-116	X		
2	511-624-532	Differential Pressure Switch, SPST Switch Action, 0.30" W.C. Setting, Sea Level to 4,000 ft. Elevation, Series 2 & 3	Tridelta	FS6707-1389		X	
2	511-624-532	Differential Pressure Switch, SPST Switch Action, 0.30" W.C. Setting, Sea Level to 4,000 ft. Elevation, Series 2 & 3	Tridelta	FS4125-117		X	
3	590-317-636	Pressure Differential Switch Tubing, 1/8" ID x 14 1/2", Red, Series 2 & 3	Weil-McLain		X	X	
4	590-317-632	Pressure Differential Switch Tubing, 1/8" ID x 7", White, Series 2 & 3	Weil-McLain		X	X	
5	512-050-235	Thermo Fuse, 121° C, Series 2 & 3	Weil-McLain		X	X	
6	510-350-062	Low Water Cut-Off Temperature Control Device, 240° F Setting, SPST Switch Action, Manual Reset (Red Manual Reset Push Button), Series 2 & 3	Hamilton-Standard	404-132	X	X	
6	510-350-062	Low Water Cut-Off Temperature Control Device, 240° F Setting, SPST Switch Action, Manual Reset (Red Manual Reset Push Button), Series 2 & 3	Thermodisc	60T25 330850	X	X	
10	510-312-166	Combination Transformer-Relay Receptacle, 120/24 Volt, 40VA (w/Bale Wire), Series 2 & 3	Honeywell	R8285 K1004	X	X	
10	510-312-166	Combination Transformer-Relay Receptacle, 120/24 Volt, 40VA (w/Bale Wire), Series 2 & 3	Products Unlimited	5701E07C5 F223	X	X	
10	510-312-166	Combination Transformer-Relay Receptacle, 120/24 Volt, 40VA (w/Bale Wire), Series 2 & 3	White-Rodgers	584A-85	X	X	
10	510-312-166	Combination Transformer-Relay Receptacle, 120/24 Volt, 40VA (w/Bale Wire), Series 2 & 3	White-Rodgers	599-9001	X	X	
11	510-350-223	Plug-In Relay, DPST, 24 Volt Holding Coil, Series 2 & 3	Honeywell	R8222 U1006	X	X	
11	510-350-223	Plug-In Relay, DPST, 24 Volt Holding Coil, Series 2 & 3	Products Unlimited	9100- 241Q223	X	X	
11	510-350-223	Plug-In Relay, DPST, 24 Volt Holding Coil, Series 2 & 3	White-Rodgers	91-112006- 11000	X	X	
11	510-350-223	Plug-In Relay, DPST, 24 Volt Holding Coil, Series 2 & 2	White-Rodgers	91-322000- 11000	X	X	