

ASTM F1807 PEX BRASS/COPPER FITTING SYSTEM

»» 6_X SERIES

Crimp™

SPECIFICATION

Sioux Chief ASTM F1807 Crimp™ brass/copper PEX fitting system shall be used in hot and cold water distribution systems and hydronic heating applications. Fittings are approved for use with ASTM F876 PEX tubing with copper crimp ring or stainless steel compression sleeve. Please contact Sioux Chief representative for specific product information within the Sioux Chief ASTM F1807 product offering.

MATERIALS

Copper, No-Lead Brass*

INSTALLATION NOTES

Full installation instructions can be found at www.siouxchief.com. Cut tube at 90-degrees. Do not crush OD of tubing with cutters. Be sure crimp/compression tool is properly calibrated. Compress with tool perpendicular to tube. Compress only once. Use a gauge to assure a proper joint. Remove defective connections. Pressure test all joints before use.

DIMENSIONS per ASTM F1807

	3/8"	1/2"	3/4"	1"
A: Ftg inside diameter	0.230" min	0.350" min	0.530" min	0.710" min
B: Copper ftg wall thickness	0.025" min	0.028" min	0.032" min	0.035" min
Brass ftg wall thickness	0.025" min	0.028" min	0.037" min	0.041" min
C: Ftg barb diameter	0.345"	0.471"	0.667"	0.856"
	+/- 0.004	+/- 0.004	+/- 0.004	+/- 0.004
D: Fitting end length	0.625" min	0.625" min	0.625" min	0.625" min

* Material is C69300 dezincification and SCC resistant, and is compliant with NSF-61 Annex G and California No Lead Plumbing Law

ITEM # SUBMITTED	_____
JOB NAME	_____
LOCATION	_____
ENGINEER	_____
CONTRACTOR	_____
PO#	_____ TAG _____

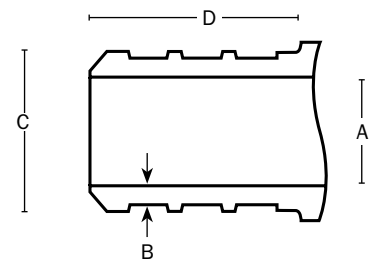

Item Number Series

632X_ = Copper MIP Elbow Adapters
632XG_ = Brass MIP Elbow Adapters
637X_ = Copper FIP Swivel Adapters
637XG_ = Brass FIP Swivel Adapters
640XG_ = Brass Plugs

641XG_ = Brass Tees
642X_ = Copper Elbows
642XG_ = Brass Elbows
643X_ = Copper MSWT Adapters
643XG_ = Brass MSWT Adapters

644X_ = Copper FSWT Adapters
644XG_ = Brass FSWT Adapters
645X_ = Copper Couplings
645XG_ = Brass Couplings
646XG_ = Brass MIP Adapters

647X_ = Copper FIP Adapters
647XG_ = Brass FIP Adapters
672X_ = Copper Manifolds
672XG_ = Brass Multi-port Tees