



The Best Products, The Best Service...

SERVICE METAL

ONE CALL GETS IT ALL

Lap Joint Flange CLASS 150 Inches / Pounds

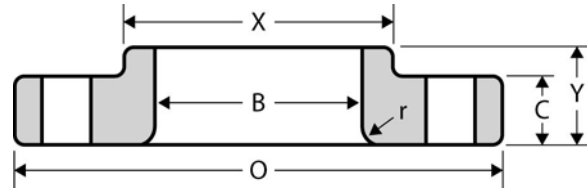

Nominal Pipe Size	Outside Diam. of Flange (O)	Thick. of Flange (C)	Diam. of Hub at Base (X)	Length thru Hub (Y)	Diam. of Bore (B)	Fillet Radius (r)	No. of Holes	Diam. of Holes	Diam. of Bolts	Diam. of Bolt Circle	Approx. Weight (in Pounds)
1/2	3.50	0.44	1.19	0.62	0.90	0.12	4	0.62	0.50	2.38	1
3/4	3.88	0.50	1.50	0.62	1.11	0.12	4	0.62	0.50	2.75	2
1	4.25	0.56	1.94	0.69	1.38	0.12	4	0.62	0.50	3.12	2
1 1/4	4.62	0.62	2.31	0.81	1.72	0.19	4	0.62	0.50	3.50	3
1 1/2	5.00	0.69	2.56	0.88	1.97	0.25	4	0.62	0.50	3.88	3
2	6.00	0.75	3.06	1.00	2.46	0.31	4	0.75	0.62	4.75	5
2 1/2	7.00	0.88	3.56	1.12	2.97	0.31	4	0.75	0.62	5.50	7
3	7.50	0.94	4.25	1.19	3.60	0.38	4	0.75	0.62	6.00	8
3 1/2	8.50	0.94	4.81	1.25	4.10	0.38	8	0.75	0.62	7.00	11
4	9.00	0.94	5.31	1.31	4.60	0.44	8	0.75	0.62	7.50	13
5	10.00	0.94	6.44	1.44	5.69	0.44	8	0.88	0.75	8.50	15
6	11.00	1.00	7.56	1.56	6.75	0.50	8	0.88	0.75	9.50	19
8	13.50	1.12	9.69	1.75	8.75	0.50	8	0.88	0.75	11.75	30
10	16.00	1.19	12.00	1.94	10.92	0.50	12	1.00	0.88	14.25	43
12	19.00	1.25	14.38	2.19	12.92	0.50	12	1.00	0.88	17.00	64
14	21.00	1.38	15.75	3.12	14.18	0.50	12	1.12	1.00	18.75	105
16	23.50	1.44	18.00	3.44	16.19	0.50	16	1.12	1.00	21.25	140
18	25.00	1.56	19.88	3.81	18.20	0.50	16	1.25	1.12	22.75	160
20	27.50	1.69	22.00	4.06	20.25	0.50	20	1.25	1.12	25.00	195
24	32.00	1.88	26.12	4.38	24.25	0.50	20	1.38	1.25	29.50	275

* Dimensions conform to ASTM A/SA-105; ANSI B16.5

Nominal Pipe Size	Outside Diam. of Flange (O)	Thick. of Flange (C)	Diam. of Hub at Base (X)	Length thru Hub (Y)**	Diam. of Bore (B)	No. of Holes	Diam. of Holes	Diam. of Bolt Circle	Approx. Weight (in Pounds)
30	38.75	2.13	32.75	3.50**	30.25	28	1.38	36.00	319
36	46.00	2.38	39.25	3.75**	36.25	32	1.63	42.75	401

* Dimensions conform to ASTM A/SA-105; ANSI B16.1

** Length thru Hub (Y) Dimension is made to Slip-On Dimension