

Submittal Data

PROJECT:	UNIT TAG:	QUANTITY:
REPRESENTATIVE: _____	TYPE OF SERVICE:	DATE: _____
ENGINEER:	SUBMITTED BY:	DATE:
CONTRACTOR:	APPROVED BY:	DATE:
	ORDER NO.:	DATE:



UP 15-18 B5

UP B is a circulator pump with a bronze pump housing for drinking water applications, while Grundfos UP N has stainless-steel pump housing. Both variants are recommended for underfloor heating systems.

Note! Product picture may differ from actual product

Conditions of Service	Pump Data	Motor Data
Liquid: Water	Liquid temperature range: 2 .. 110 °C	Max. power input: 85 W
Temperature: 60 °C	Maximum ambient temperature: 40 °C	Mains frequency: 60 Hz
Specific Gravity: 0.985	Type of connection: Brz. Sweat	Thermal protection: Impedance protected
	Pipe connection: 1/2" INT. SWEAT	
	Product number: 59896114	

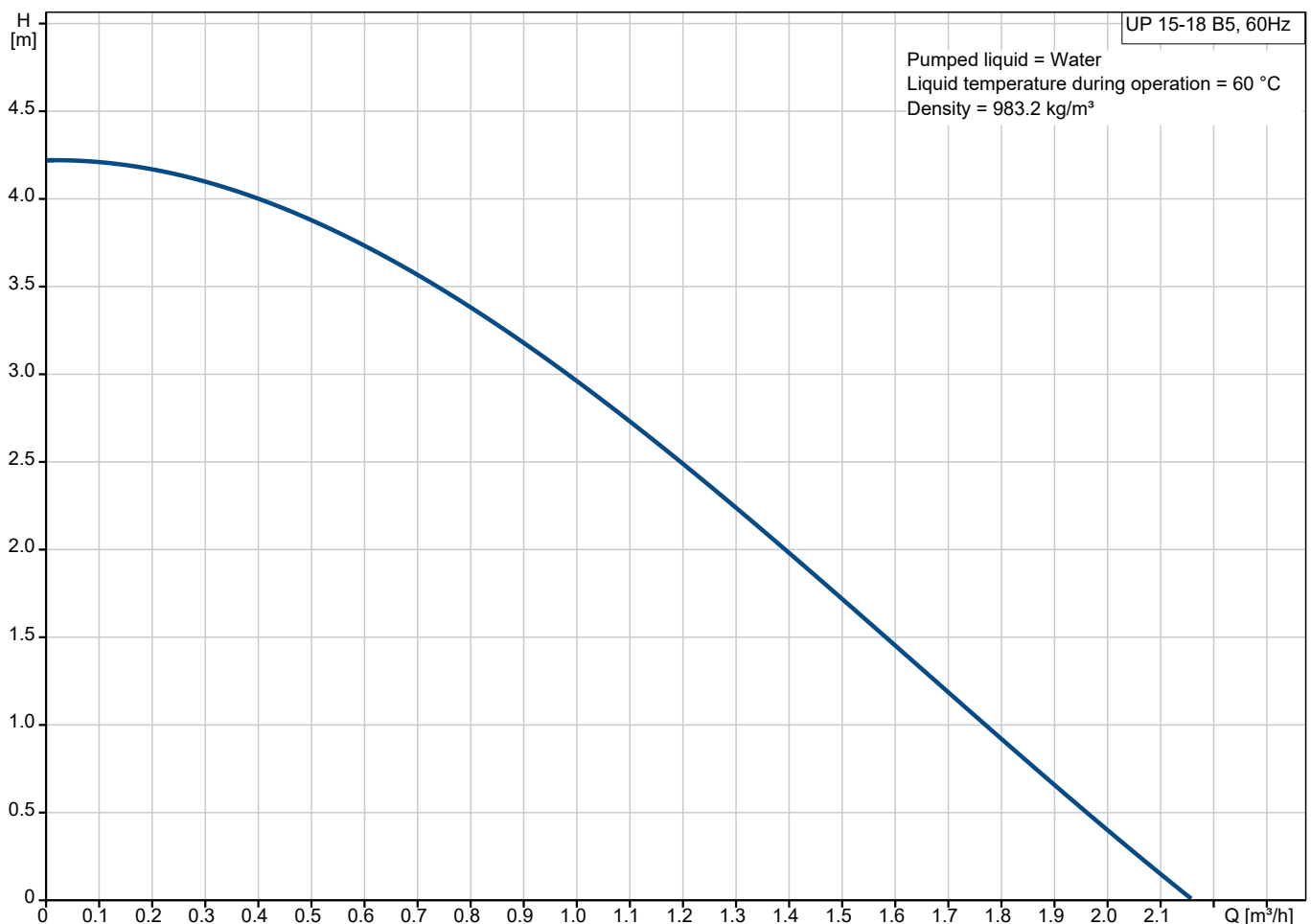

Submittal Data

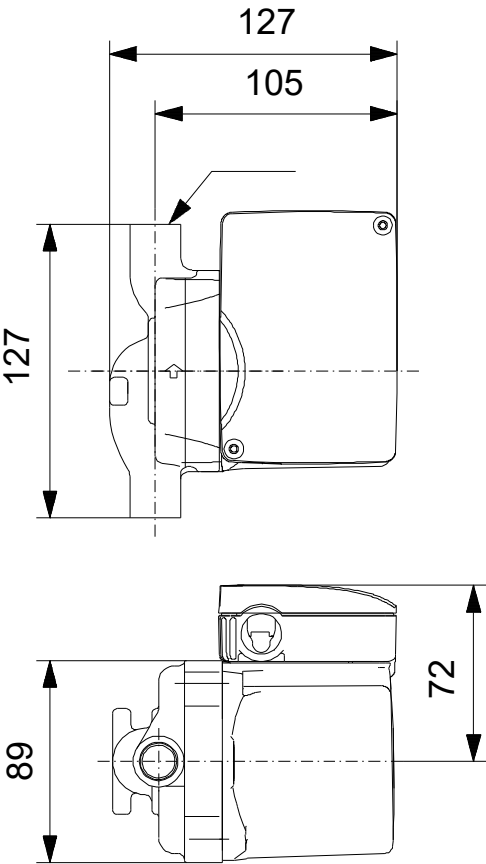

Materials:
Pump housing: Bronze
ASTM B584 C87500
Impeller: Composite

Qty.	Description
------	-------------

1	UP 15-18 B5
---	-------------



Note! Product picture may differ from actual product

Product No.: [59896114](#)

Grundfos UP B circulator pumps have a bronze pump housing for drinking water applications while Grundfos UP N have a stainless-steel pump housing. Both variants are recommended for underfloor heating systems as the pumped liquid may often become aerated, causing corrosion in cast iron pump housings.

The pump is of the canned rotor type, i.e. pump and motor form an integral unit without shaft seal and with only two gaskets for sealing. The bearings are lubricated by the pumped liquid. The pump is characterized by:

- Ceramic shaft and radial bearings.
- Carbon axial bearing.
- Stainless steel rotor can and bearing plate.