

Gruvlok® DI-LOK™ CTS x IPS Groove Di-Electric Fitting Fig. 7091



Material Specifications

Housing

Seamless Carbon Steel to ASTM A106

Coating

Nylon conforming to ANSI/NSF-61

The Gruvlok Fig. 7091 DI-LOK Fitting prevents the formation of a galvanic cell between grooved end steel pipe and copper tube. The separation of copper from steel by the fitting virtually eliminates the galvanic cell created by the dissimilar metals.

The DI-LOK Fitting is designed for use at temperatures from -40°F to 230°F (-40°C to 110°C) and pressures to 300 PSI (20.7 bar) in a wide range of applications.



PROJECT INFORMATION	APPROVAL STAMP
Project:	Approved
Address:	Approved as noted
Contractor:	Not approved
Engineer:	Remarks:
Submittal Date:	
Notes 1:	
Notes 2:	

Gruvlok® DI-LOK™ CTS x IPS Groove Di-Electric Fitting Fig. 7091

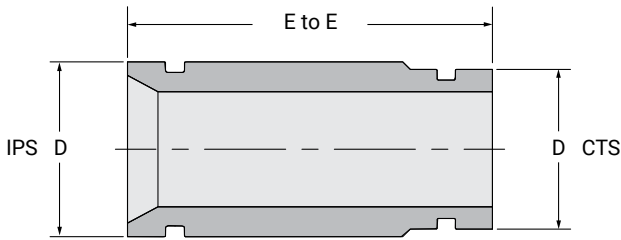

Nominal Size	Copper (CTS)	Steel (IPS)	End to End	Approx. Wt. Ea.
	D Actual	D Actual		
IPS	In./mm	In./mm	In./mm	Lbs./kg
2	2.125	2.375	4.0	1.76
50	53.98	60.33	101.60	0.80
2½	2.625	2.875	6.0	3.66
65	66.68	73.03	152.40	1.66
3	3.125	3.500	6.0	5.23
80	79.38	88.90	152.40	2.37
4	4.125	4.500	6.0	6.88
100	104.78	114.30	152.40	3.12
6	6.125	6.625	6.0	13.80
150	155.58	168.28	152.40	6.26
8	8.125	8.625	6.0	18.91
200	206.38	219.07	152.40	8.58



asc-es.com

Building connections that last™