

*This Part requires three clamps, part numbers 128-300, 152-300 & 212-300. See additional drawings for information on these parts.

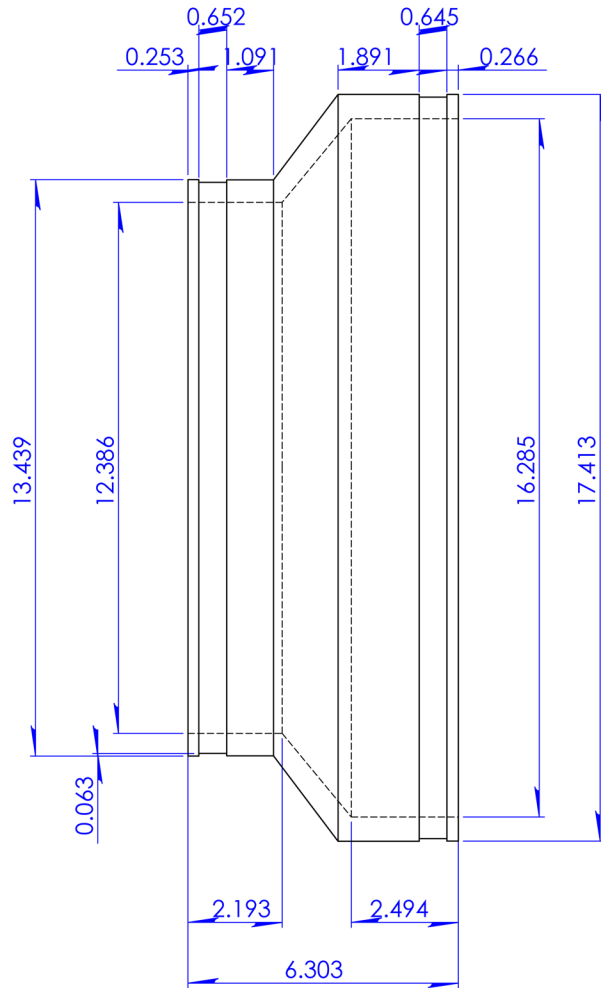

NOTES:
 -SOME HIDDEN LINES NOT SHOWN
 -BREAK ALL SHARP CORNERS
 -REPORT ALL CHANGES TO ENGINEERING

PROPRIETARY AND CONFIDENTIAL
 THE INFORMATION CONTAINED IN THIS DRAWING IS THE SOLE PROPERTY OF FERNCO, INC. ANY REPRODUCTION IN PART OR AS A WHOLE WITHOUT THE WRITTEN PERMISSION OF FERNCO, INC. IS PROHIBITED.

Part Weight	
Min/Max Temp.	-30/140 Degrees F
Pressure Tested	4.3 PSI
Material	Flexible PVC
Installation Torque	60" Lbs.
Conforms to ASTM	D5926
Box Quantity	40
Clamps used	300 Series

TOLERANCES:
 .X= Fractional ±
 .XX= ±.02
 .XXX= ±.030
 ANG.= ±0.5°
 UNLESS OTHERWISE SPECIFIED

DESCRIPTION:	
Coupling 12" Concrete x 12" Plastic/Cast Iron	
1006-1212	
UNITS:	DESIGNER:
INCHES	D. Brady
SIZE:	CHECKER:
A	DATE: 7/11/2008
3RD ANGLE PROJECTION DO NOT SCALE DRAWING	SHEET 1 OF 1

SCALE
not to scale