

77CLF-100 SERIES

Lead Free* Bronze Full Port Ball Valve (Threaded)

Threaded, 600 psig CWP, 150 psig SWP. (See referenced P/T chart)
 Vacuum Service to 29 inches Hg.
 MSS SP-110; Ball Valves
 CRN: OC10908.5C



FEATURES

- Lead-Free Brass & Bronze Materials
- Multi-Fill PTFE Seats & Seals
- Blow-out Proof Stem Design
- NSF-372, Drinking Water System Components - Lead Content
- Adjustable stem packing
- Full Port "Solid Ball" Design
- 100% Factory Tested
- NSF/ANSI 61 (2010) Section 8, Annex F & G

VARIATIONS AVAILABLE:

77CLF-140 Series (316 SS Ball & Stem)

OPTIONS AVAILABLE: (More information in Section J)

(SUFFIX)	OPTION	SIZES
-01	Standard Configuration	All
-04-	2.25" CS Stem Extension	1/4" to 2.5"
-07-	Steel Tee Handle	1/4" to 2"
-10-	S.S. Handle and Nut	1/4" to 2"
-11-	Therma-Seal™ Insulating Tee Handle	1/4" to 2"
-27-	Locking Handle	1/4" to 2"
-92-	Balancing Stop	1/4" to 2"
-94-	2.25" Stem Ext. & Balancing Stop	1/4" to 2"
-A3-	Plain Grip	1/4" to 2"

STANDARD MATERIAL LIST

PART	MATERIAL
1 Packing	MPTFE
2 Seat	MPTFE
3 Stem	C27451 Lead-Free* Brass
4 Ball	C27451 Lead-Free* Brass Cr. Plated
5 Retainer	C27451 Lead-Free* (1/4"-1/2") C89836 Lead-Free* Bronze (3/4"-2")
6 Body	C89836 Lead Free* Brz
7 Handle	Zinc Plated Steel/Vinyl

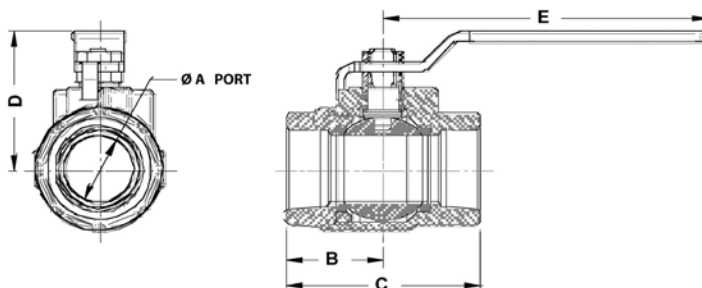

PRODUCT NUMBER	SIZE	A	B	C	D	E	F	G	CV	WT.**
77CLF-101-01	1/4"	0.37	0.95	1.97	1.76	3.74	-	-	4.5	0.6
77CLF-102-01	3/8"	0.37	1.07	2.09	1.76	3.74	-	-	7.2	0.6
77CLF-103-01	1/2"	0.50	1.15	2.25	1.79	3.74	-	-	15.5	0.6
77CLF-104-01	3/4"	0.75	1.32	2.65	2.00	4.88	-	-	35.6	1.1
77CLF-105-01	1"	1.00	1.53	3.07	2.19	4.88	-	-	68.1	1.8
77CFL-106-01	1.25"	1.25	2.04	4.08	3.13	7.06	-	-	125.0	4.4
77CLF-107-01	1.5"	1.50	2.12	4.43	3.29	7.06	-	-	177.0	4.6
77CLF-108-01	2"	2.00	2.43	4.85	3.83	7.06	-	-	389.0	7.9
77CLF-109-01	2.5"	2.50	3.12	6.37	4.51	8.06	-	-	503.0	16.2

**Weights are based on standard configuration.



* LEAD FREE: The wetted surfaces of this product shall contain no more than 0.25% lead by weighted average. Complies with CA AB1953, VT Act 193, MD HB372, LA HB471 and Federal Public Law 111-380. ANSI 3rd party approved and listed.

FOR PRESSURE/TEMPERATURE RATINGS, REFER TO PAGE M-10, GRAPH NO. 4

