



Streamline® ACR Copper Press Fittings are designed to join ASTM B280 and ASTM B88 (Types ACR, K and L) hard-drawn copper tube from 1/4" to 1-1/8" as well as ASTM B280 and ASTM B1003 soft (annealed) copper tube up to 7/8".

OPERATING PARAMETERS:

- Operating Pressure: 700 PSI / 48 Bar Max
- Operating Temperature: -40°F - 250°F / -40°C - 121°C
- Seal Temperature Rating: -40°F - 300°F / -40°C - 149°C
- Burst Pressure: Minimum 2,100 PSI / 144 Bar
- Vacuum Capability: 200 Microns
- Helium Leak Tightness: 7.5 x 10⁻⁷ Pa.m³/s at +20°C

APPROVALS & CERTIFICATIONS:

- UL 207 • UL 1963 • UL 109
- ISO 14903 • ISO 5149-2
- (IMC) International Mechanical Code
- (IRC) International Residential Code
- (UMC) Uniform Mechanical Code
- ASHRAE 15
- ASME B31.5
- CSA C22.2 No. 140.3-15

APPROVED APPLICATIONS:

- Air Conditioning
- Heat Pump
- VRF and VRV
- Light Commercial Refrigeration
- Non-Potable Water
- Ethylene Glycol

10-YEAR LIMITED WARRANTY



DIMENSIONAL DATA

90° ELBOW

P X P

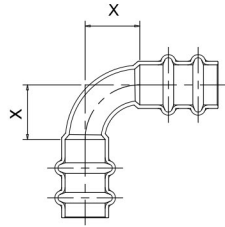

Item No.	Diameter	Catalog Wt.	Inner	Master	Dimensions (In.)	
					X	
RP02715	1/4"	0.04	5	750	0.51	
RP02716	3/8"	0.07	5	450	0.75	
RP02717	1/2"	0.11	5	250	0.75	
RP02722	5/8"	0.17	3	150	0.87	
RP02728	3/4"	0.22	3	120	1.08	
RP02734	7/8"	0.27	3	105	1.08	
RP02747	1-1/8"	0.39	2	60	1.30	

90° ELBOW • STREET

FTG X P

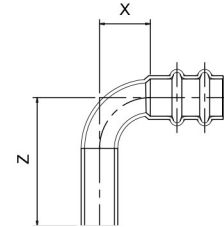

Item No.	Diameter	Catalog Wt.	Inner	Master	Dimensions (In.)	
					X	Z
RP02808	1/4"	0.03	5	750	0.51	1.56
RP02809	3/8"	0.07	5	500	0.75	1.87
RP02817	1/2"	0.10	5	300	0.75	1.93
RP02822	5/8"	0.16	3	150	0.87	2.19
RP02828	3/4"	0.20	3	135	1.08	2.42
RP02834	7/8"	0.26	3	105	1.08	2.52
RP02847	1-1/8"	0.37	2	60	1.30	2.83

45° ELBOW

P X P

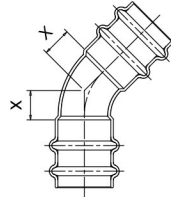

Item No.	Diameter	Catalog Wt.	Inner	Master	Dimensions (In.)	
					X	
RP03005	1/4"	0.04	5	750	0.28	
RP03012	3/8"	0.06	5	450	0.35	
RP03021	1/2"	0.11	5	250	0.37	
RP03026	5/8"	0.16	3	150	0.43	
RP03030	3/4"	0.20	3	120	0.55	
RP03034	7/8"	0.25	3	105	0.55	
RP03044	1-1/8"	0.35	2	60	0.63	

CAP

P

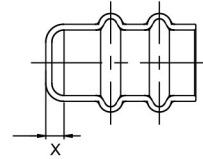

Item No.	Diameter	Catalog Wt.	Inner	Master	Dimensions (In.)	
					X	
RP07002	1/4"	0.02	5	400	0.10	
RP07004	3/8"	0.03	5	400	0.16	
RP07006	1/2"	0.05	5	400	0.18	
RP07007	5/8"	0.07	2	300	0.22	
RP07008	3/4"	0.09	2	200	0.18	
RP07009	7/8"	0.11	2	160	0.18	
RP07011	1-1/8"	0.15	1	90	0.18	

COUPLING • STAKED STOP

P X P

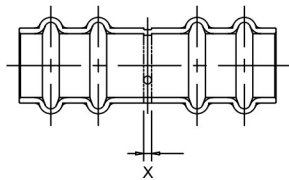

Item No.	Diameter	Catalog Wt.	Inner	Master	Dimensions (In.)	
					X	
RP10141	1/4"	0.03	5	900	0.08	
RP10143	3/8"	0.05	5	600	0.08	
RP10144	1/2"	0.09	5	300	0.08	
RP10145	5/8"	0.13	5	225	0.08	
RP10157	3/4"	0.15	2	150	0.08	
RP10146	7/8"	0.19	2	90	0.08	
RP10147	1-1/8"	0.27	2	70	0.08	

COUPLING • REDUCING

P

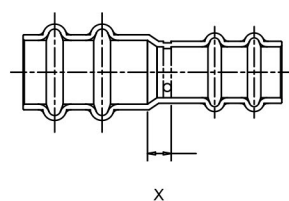

Item No.	Diameter	Catalog Wt.	Inner	Master	Dimensions (In.)	
					X	
RP01011	3/8" x 1/4"	0.04	5	600	0.24	
RP01019	1/2" x 3/8"	0.07	5	300	0.24	
RP01025	5/8" x 3/8"	0.04	5	160	0.35	
RP01023	5/8" x 1/2"	0.12	2	160	0.24	
RP01029	3/4" x 5/8"	0.14	2	150	0.24	
RP01035	7/8" x 3/4"	0.18	2	110	0.24	
RP01050	1-1/8" x 3/4"	0.10	1	60	0.51	
RP01051	1-1/8" x 5/8"	0.10	1	60	0.43	
RP01049	1 1/8" x 7/8"	0.25	1	60	0.31	

C
COPPER

PR
PRESS

H
HVAC/R

TEE P X P

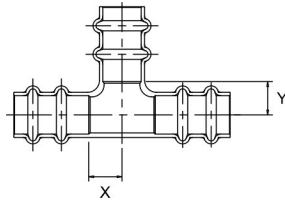

Item No.	Diameter	Catalog Wt.	Inner	Dimensions (In.)	
				X	Y
RP04000	3/8"	0.19	5	0.39	0.39
RP04001	1/2"	0.35	5	0.47	0.47
RP04006	5/8"	0.47	2	0.55	0.55
RP04017	3/4"	0.33	2	0.59	0.59
RP04031	7/8"	0.47	2	0.67	0.67
RP04048	1-1/8"	0.91	1	0.79	0.79

FLARE P X FLR SAE

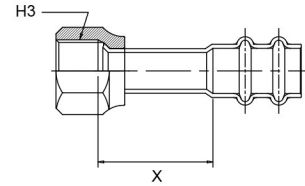

Item No.	Diameter	Catalog Wt.	Inner	Master	Dimensions (In.)	
					X	H3
RP15725	1/4"	0.07	5	225	1.46	7/16"-20 UNF
RP15726	3/8"	0.13	5	300	1.50	5/8"-18 UNF
RP15727	1/2"	0.22	5	180	1.50	3/4"-16 UNF
RP15728	5/8"	0.30	2	130	1.61	7/8"-14 UNF
RP15729	3/4"	0.46	2	50	1.95	1-1/16"-14 UNS

ALSO AVAILABLE

CYCLEMASTER® BALL VALVES

FTG X FTG

Item No.	Diameter	Catalog Wt.	Inner	Master
----------	----------	-------------	-------	--------

FTG x FTG Multi Split Ball Valve, with Access Port

A 18959	1/4"	0.69	1	32
A 18960	3/8"	0.61	1	32
A 18961	1/2"	0.59	1	32
A 18962	5/8"	0.62	1	32
A 18963	3/4"	0.86	1	24
A 18964	7/8"	0.87	1	12

FTG x FTG Multi Split Ball Valve, with Access Port & Insulation

A 19101U	1/4"	0.69	1	22
A 19102U	3/8"	0.61	1	22
A 19103U	1/2"	0.59	1	22
A 19104U	5/8"	0.62	1	22

FTG x FTG Ball Valve

AF17865	1-1/8"	1.71	1	10
---------	--------	------	---	----

FTG x FTG Ball Valve, with Access Port

AG17865	1-1/8"	1.78	1	10
---------	--------	------	---	----

C
COPPER

PR
PRESS

H
HVAC/R