

# 442-SERIES

Battery Back-Up Pumps

# Liberty Pumps®

A Family and Employee Owned Company

## Away from home? Power outage? Liberty Pumps has you covered.

# StormCell®

Dual 12-volt  
Battery Box Shown

Liberty Pumps StormCell® battery back-up pumps provide uninterrupted flood control for your basement in the event of a power outage or main pump failure. These highly advanced 12-volt back-up pump systems are available as standard models or with optional NightEye® wireless technology. With NightEye enabled models, you have one of the most advanced pump systems on the market - providing intelligent monitoring via the NightEye app and real time notifications via text message, email or push notification



Patent: See  
[www.LibertyPumps.com/patents](http://www.LibertyPumps.com/patents)



Battery not included with system



NightEye®  
Wireless Enabled  
Models Available

# innovate. evolve.

## 442-10A Series Standard System 10 AMP Single Battery

### Features

- Energy efficient 12V DC Pump (Manufactured in the USA by Liberty Pumps)
- Professional-grade 10A charger/controller
- 6' Power cord on charger, 8' Power cord on pump
- Suitable with Wet Cell, AGM or gel-type batteries
- Microprocessor controlled with energy efficient Switch Mode Technology
- Single battery box accommodates (1) Group 27 or 31 battery
- Remote wall-mount user interface with LCD display
- Audio alarm (features a self-reset after silence)
- Super-bright red LED alarm ring
- 9-volt battery backup – operates alarm in standby mode for up to 72 hours
- Alarm and pump test buttons
- Green LED AC power light and audible notification of power loss
- Blue LED Pump-Run light
- Auxiliary contacts (24VDC, 100 mA max)
- Compact "snap-on" activation float switch with integral alarm float switch (fits 1-1/4" and 1-1/2" pipe)
- High water float switch acts as a redundant "on" float switch for the pump
- Tee and fittings for standard installations

## 442-25A Series High-output System 25 AMP Dual Battery

### Features

- Energy efficient 12V DC Pump (Manufactured in the USA by Liberty Pumps)
- Heavy-duty fan cooled 25A charger. (Can run as a continuous power supply for the back-up pump in the event of a main pump failure)
- 6' Power cord on charger, 8' Power cord on pump
- Suitable with Wet Cell, AGM or gel-type batteries
- Dual battery box accommodates (2) Group 27 or 31 batteries
- Microprocessor controlled with energy efficient Switch Mode Technology
- Remote wall-mount user interface with LCD display
- Audio alarm (features a self-reset after silence)
- Super-bright red LED alarm ring
- 9-volt battery backup – operates alarm in standby mode for up to 72 hours
- Alarm and pump test buttons
- Green LED AC power light and audible notification of power loss
- Blue LED Pump-Run light
- Auxiliary contacts (24VDC, 100 mA max)
- Compact "snap-on" activation float switch with integral alarm float switch (fits 1-1/4" and 1-1/2" pipe)
- High water float switch acts as a redundant "on" float switch for the pump
- Tee and fittings for standard installations



### 442-10A Series Performance

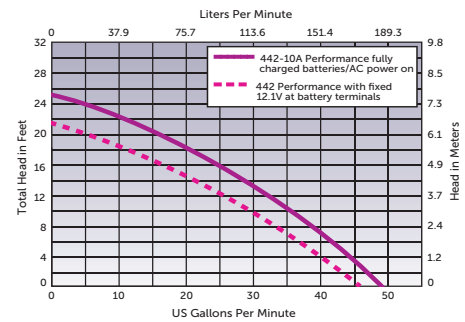

### 442-25A Series Performance

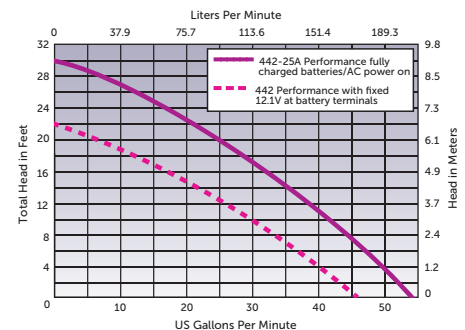

Liberty Pumps®



# NightEye®



Apple® iOS & Android® compatible

FREE App!



## Wireless Enabled

Both the 10A and 25A systems are available with optional wireless enabled technology. The NightEye® cloud-based system provides constant monitoring of your back-up pump – providing you instant information to your smart device – anywhere in the world.

### Notifications

- Back-up pump activation
- High water level alarm
- AC power lost
- Wi-Fi connection lost (system utilizes a smart wireless connection monitor to prevent nuisance notifications)
- Blown fuse or DC pump failure
- 12-volt battery charge levels
- Critically low battery warning
- Basement temperature level warning (user sets temperature warning level)

### Other Features

- No subscription or user fees (message and data rates may apply)
- System works through your home's wireless router
- Simple and easy connection using BlinkUp™ technology
- 9-volt battery backup on control device will operate for up to 12 hours in active alarm mode and 7 days in standby mode
- Silence or test alarm remotely from your smart device

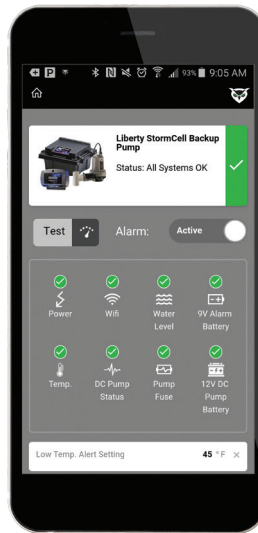

Normal Status

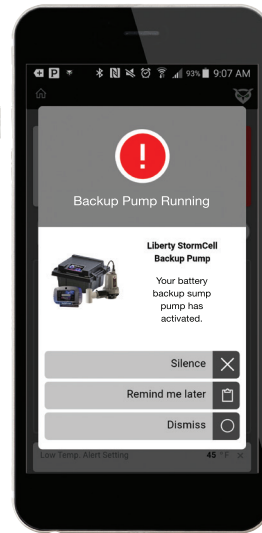

Back-Up Pump Running

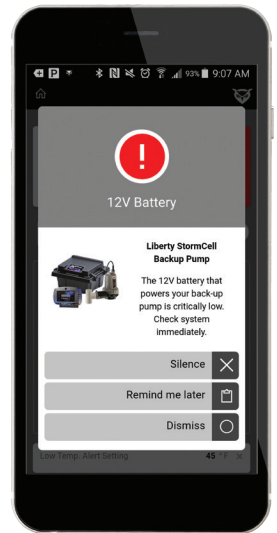

Low Battery Level



Patent: See [www.LibertyPumps.com/patents](http://www.LibertyPumps.com/patents)

Super-bright LED alarm ring



# Liberty Pumps®

# StormCell®

### All Systems Include:

- Back-up Pump
- Battery Case
- Activation Switch
- Control Panel/Alarm
- Charger Unit
- Check Valve
- Plumbing And Mounting Components
- AC Power Supply

Choose between wireless enabled or standard models

### NightEye® WIRELESS ENABLED MODELS

### STANDARD MODELS



**442-10A-EYE**



**442-25A-EYE**



**442-10A**



**442-25A**

		442-10A-EYE	442-25A-EYE	442-10A	442-25A
<b>Max Flow</b> (GPM)	@ 12.1V	46	46	46	46
	with AC Power On	49	54	49	54
<b>Flow at 10'</b> (GPM)	@ 12.1V	30	30	30	30
	with AC Power On	35	42	35	42
<b>Continuous Run Times*</b> (with StormCell® Group 31 Wet Cell batteries)		5.5 Hours (~8,000 gallons)	11 Hours (~16,000 gallons)	5.5 Hours (~8,000 gallons)	11 Hours (~16,000 gallons)
<b>Cycling Run Times**</b> (with StormCell® Group 31 Wet Cell batteries)		8 Days	16 Days	8 Days	16 Days
<b>Run Times/Gallons</b> (AC Power On)		Unlimited (performance will decline as battery discharges)	Unlimited at Rated Curve (25A Charger supports continuous run)	Unlimited (performance will decline as battery discharges)	Unlimited at Rated Curve (25A Charger supports continuous run)
<b>Max Lift</b>	@ 12.1V	21.5'	21.5'	21.5'	21.5'
	with AC Power On	25'	30'	25'	30'
<b>User Interface with LCD Display</b>		✓	✓	✓	✓
<b>NightEye® Wireless Enabled</b>		✓	✓		
<b>High-output Dual Battery System</b> (Batteries sold separately)			✓		✓
<b>Weight (lbs)</b>		20	30	20	30

Continuous run at 10' lift. \*\*Based on 10' lift and pumping 10 gallons per cycle - 4 times an hour.

### Certifications



Specifications subject to change without notice.

Copyright © Liberty Pumps, Inc. 2023 All rights reserved. LLIT006746-R07/23

Liberty Pumps - 7000 Apple Tree Avenue - Bergen, New York 14416  
Phone 800-543-2550 - Fax 585-494-1839 - LibertyPumps.com