

Short Type Hose Couplings for Vapor and Liquid Service 3171, 3175, 3181, 3185 and 3195 Series

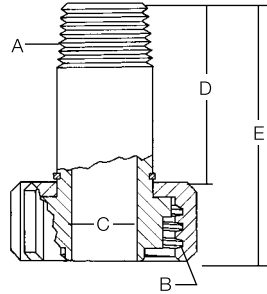

3175 Series



**Style A
For Liquid Filling**



A3185 Series

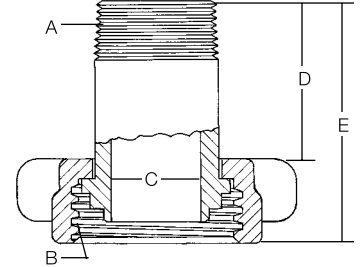

**Style B
For Liquid Filling**



3171A Series

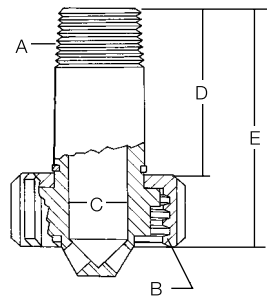

**Style C
For Vapor Equalizing**



3191 Series

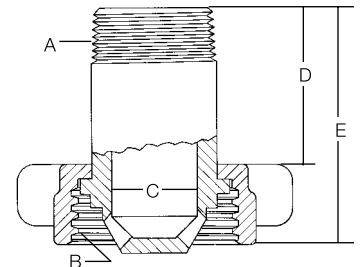

**Style D
For Vapor Equalizing**



Ordering Information

Part Number	Material	Style	A. Hose Connection (M. NPT)	B. Coupling Connection (F. ACME)	C. Tailpiece Bore	D. Hose End To Nut	E. Overall Length
3175B	Brass	A	1/2"	1 1/4"	35/64"	1 1/16"	2 1/16"
3175			3/4"		3/4"		
3175A			1"		15/16"		
3185	Brass Nut & Steel Nipple	B	1 1/4"	2 1/4"	1 3/16"	2 1/16"	3 3/4"
3195			2"	3 1/4"	7/8"	2 1/4"	3 5/8"
A3175	Steel	A	3/4"	1 3/4"	3/4"	2"	2 7/8"
A3175A			1"		7/8"	2 1/4"	3 1/8"
A3185		B	1 1/4"	2 1/4"	1 1/4"	2 1/8"	3 3/16"
A3195	2"		3 1/4"	1 7/8"	2 1/4"	3 5/8"	
3171	Brass	C	3/8"	1 1/4"	3/8"	1 11/32"	2 19/32"
3171A			1/2"		31/64"		
3181			3/4"	1 3/4"	3/4"	1 3/16"	2 1/16"
3181A			1"		3/4"	1 7/8"	2 3/4"
3191	D	1 1/4"	2 1/4"	1 3/16"	2 5/8"	3 3/16"	