

CGT Gas Control Assembly

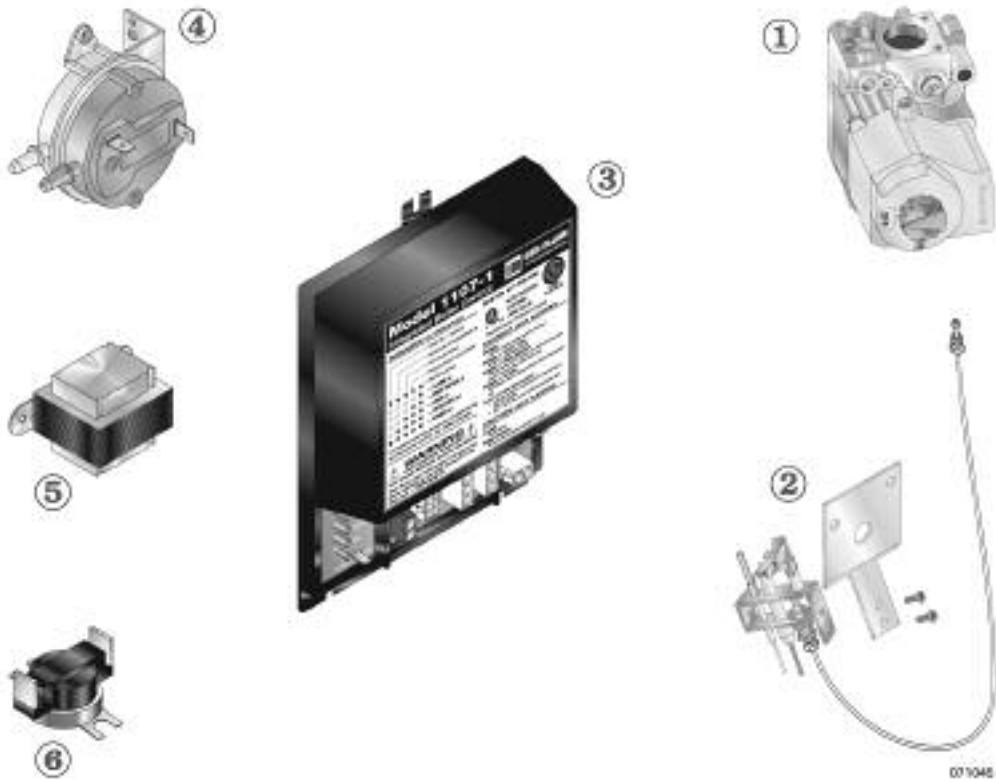

Item number	Description	Manufacturer		W I-L
1	Gas valve, Ω " x Ω "	Honeywell White-Rodgers	VR8204A2001 36E36-266	511-044-381 511-044-381
2	Pilot kit w/orifice & aluminum pilot gas tubing	Weil-McLain		511-330-080
3	Control module	United Technologies	1107-1	511-330-090
4	Air pressure switch, 1.53" w.c.	Tri-Delta		511-624-542
5	Control transformer			511-842-370
6	Ambient temperature switch (bracket not shown); 135°F; automatic reset	Therm-O-Disc	60T21 314367	540-130-401
NS	Tubing, air pressure switch, 0.12 I.D. silicone red, to collector hood white, to transition	Lydall		590-317-650 590-317-651
NS	Control wiring harness			591-391-920

CGs Gas Controls

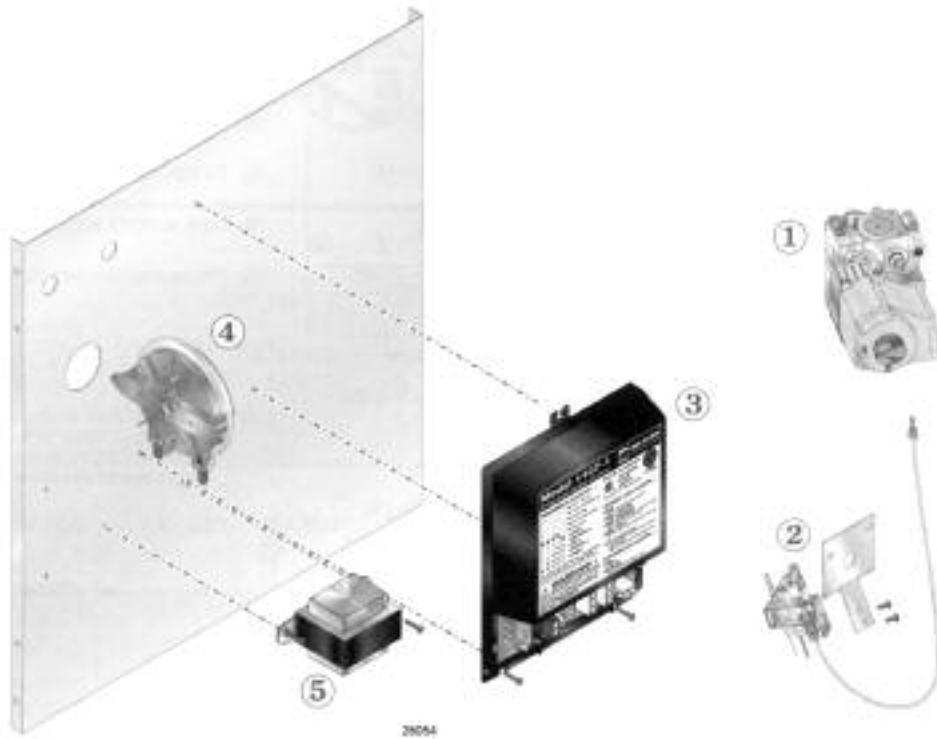

Fig. No.	Part No.	Description	Mfr.	Mfr.'s Part No.	Boiler Size	Notes
NATURAL GAS COMPONENTS						
1	381-356-532	Gas Valve, 1/2" x 1/2" with hose barb(Replacement kit)	Honeywell	VR8204A-2001	All	
2	511-330-080	Pilot Assembly Kit with Orifice and Aluminum Pilot Gas Tubing	PSE	PSE-NA231	All	
PROPANE GAS COMPONENTS						
1	381-356-533	Gas Valve, 1/2" x 1/2" with hose barb(Replacement kit)	Honeywell	VR8204M-2719	All	
2	511-330-081	Pilot Assembly Kit with Orifice and Aluminum Pilot Gas Tubing	PSE	PSE-LP231	All	
NATURAL GAS AND PROPANE GAS COMPONENTS						
3	511-330-090	Control Module with 10 second pre-purge	United Technologies	1107-1	All	
NS	591-391-894	Wiring Harness	Weil-McLain		All	
4	511-624-401	Air Pressure Switch 0' to 1999', 1.79" W.C.	Tri-Delta	PPS10171-3013	3	
	511-624-402	Air Pressure Switch 0' to 1999', 1.48" W.C.	Tri-Delta	PPS10171-3014	4	
	511-624-403	Air Pressure Switch 0' to 1999', 1.22" W.C.	Tri-Delta	PPS10171-3015	5	
	511-624-404	Air Pressure Switch 0' to 1999', .95" W.C.	Tri-Delta	PPS10171-3016	6	
5	511-842-370	Control Transformer, 24 V. Sec. 40 VA	Honeywell		All	
	511-842-370	Control Transformer, 24V. Sec. 40 VA	Basler Elec.	BE111640 GDD		
NS	590-317-650	Tubing, Air Pressure Switch, 1/8" I.D. x 15" Silicone, Red to Collector Hood	Weil-McLain		All	
NS	590-317-651	Tubing, Air Pressure Switch, 1/8" I.D. x 17" Silicone, White to Transition	Weil-McLain		All	
NS	510-811-096	Natural to LP Conversion Kit CGs 3-6			All	
NS	510-811-097	LP To Nat Conversion Kit CGs 3-6			All	

CGi Series 2 Gas Controls

Fig. No.	Part No.	Description	Mfr.	Mfr.'s Part No.	Boiler Size	Notes
NATURAL GAS COMPONENTS						
1	511-044-381	Gas Valve, 1/2" x 1/2", Natural Gas	Honeywell	VR8204A-2001	25, 3, 4, 5, 6	
			White-Rodgers	36E36-266		
	511-044-353	Gas Valve, 3/4" x 3/4", Natural Gas	Honeywell	VR8304M-4002	7, 8	
			White-Rodgers	36C68-478		
2	511-330-080	Pilot Burner Assembly Kit W/Orifice & Aluminum Pilot Gas Tubing, Natural Gas	PSE	PSE-NA231	All	
PROPANE GAS COMPONENTS						
1	511-044-354	Gas Valve, 1/2" x 1/2", Propane Gas	Honeywell	VR8204M-2701	25, 3, 4, 5, 6	
	511-044-355	Gas Valve, 3/4" x 3/4", Propane Gas	Honeywell	VR8304M-4010	7, 8	
2	511-330-081	Pilot Burner Assembly Kit W/Orifice & Aluminum Pilot Gas Tubing, Propane Gas	PSE	PSE-LP231	All	
NATURAL GAS AND PROPANE GAS COMPONENTS						
2a	450-003-689	Pilot Bracket	Weil-McLain		All	
NS	N/A	Maching Screw, Pan Head Phillips, 10-32 x .19" Zinc Plated (2 each for pilot bracket) (Purchase Locally)			All	
3	511-330-090	Control Module with 10 second pre-purge	United Technologies	1107-1	All	
NS	591-391-894	Wire Harness, Controls to Control Module	Weil-McLain		All	
NS	591-391-900	Wire harness, J-Box to Control Module	Weil-McLain		All	
4	511-624-401	Air Pressure Switch, 1.79" W.C.	Tri-Delta	PPS10171-3013	25, 3	
	511-624-302	Air Pressure Switch, 1.40" W.C.	Tri-Delta	PPS10171-3094	4	
	511-624-303	Air Pressure Switch, 1.22" W.C.	Tri-Delta	PPS10171-3095	5	
	511-624-304	Air Pressure Switch, 0.80" W.C.	Tri-Delta	PPS10171-3096	6, 8	
	511-624-405	Air Pressure Switch, 0.75" W.C.	Tri-Delta	PPS10171-3031	7	
5	511-842-370	Control Transformer, 24 V. Secondary, 40 VA	Honeywell	AT140B-1297	All	
			Basler Electric	BE111640 GDD		
NS	590-317-650	Tubing, Air Pressure Switch, 1/8" I.D. x 17" Silicone, Red to Collector Hood	Manufacturer Rubber Supply		All	
	590-317-651	Tubing, Air Pressure Switch, 1/8" I.D. x 19" Silicone, White To Transition	Manufacturer Rubber Supply		All	
NS	510-811-830	Natural to Propane Conversion Kit CGi 25				
NS	510-811-831	Natural to Propane Conversion Kit CGi 3-6				
NS	510-811-832	Natural to Propane Conversion Kit CGi 7-8				
NS	510-811-833	Propane to Natural Conversion Kit CGi 25				
NS	510-811-834	Propane to Natural Conversion Kit CGi 3-6				
NS	510-811-835	Propane to Natural Conversion Kit CGi 7-8				

CGa Control Parts

Fig. No.	Part No.	Description	Mfg.	Mfg.'s Part No.	Boiler Size	Notes
STANDING PILOT – NATURAL GAS COMPONENTS						
1	511-044-360	Gas Valve, 1/2" x 1/2"	Honeywell	VR8200A-2116	25 – 6	
			Grayson	7A0-A1B-042		
1	511-044-256	Gas Valve, 3/4" x 3/4"	Honeywell	VR8300C-4050	7, 8	
2	510-811-644	Pilot Assembly Kit with Orifice	Weil-McLain		All	
3	560-742-860	Tubing, Pilot, Aluminum 1/8" x 22.75	Weil-McLain		All	
4	511-724-254	Thermocouple, 30"	Honeywell	Q309A-1988	All	
STANDING PILOT – PROPANE GAS COMPONENTS						
1	511-044-258	Gas Valve, 1/2" x 1/2"	Honeywell	VR8200C-1074	25 – 6	
1	511-044-257	Gas Valve, 3/4" x 3/4" 1.2" step	Honeywell	VR8300C-4100	7, 8	
2	510-811-646	Pilot Assembly Kit with Orifice	Weil-McLain		All	
3	560-742-860	Tubing, Pilot, Aluminum 1/8" x 22.75	Weil-McLain		All	
4	511-724-253	Thermocouple, 48"	Honeywell	Q309A-1988	All	
STANDING PILOT COMPONENTS FOR NATURAL GAS AND PROPANE GAS						
5	510-312-167	Transformer and Relay Assembly	Honeywell	R8285D-1000	All	
			White-Rodgers	631-9001		
NS	510-350-223	Relay Only – Standing Pilot	White-Rodgers	91-322000-11000	All	
NS	510-312-166	Transformer Only – Standing Pilot	Hamilton	599-9001	All	
NS	591-391-862	Standing Pilot Wiring Harness	Weil-McLain		All	
PILOT GAS COMPONENTS FOR NATURAL AND PROPANE – CGa 25 & CGa 3 ONLY						
NS	510-933-126	Pilot Gas Pressure Regulator, 4.0" W.C. Outlet	Maxitrol	RV12LT-11	25, 3	
			SCP Inc.	SC-50N		
		560-742-859	Tubing, Aluminum from Gas Valve to Regulator, 1/4" x 3" 90 degree	Weil-McLain		25, 3
	562-302-017	Adapter, Male 1/8" x 7/16"-24, from Regulator to Pilot Gas Line	Weil-McLain		25, 3	
SPARK IGNITION COMPONENTS FOR NATURAL GAS						
6	511-044-381	Gas Valve, 1/2" x 1/2"	Honeywell	VR8204A-2001	25 – 6	
			White-Rodgers	36E36-266		
			Grayson Control	7200IPER 7D1-D5B-029		
6	511-044-382	Gas Valve, 3/4" x 3/4"	Honeywell	VR8304P-4348	7, 8	
			White-Rodgers	36C74-474		
7	511-330-218	Pilot Assembly Kit with orifice and Aluminum Pilot Gas Tubing	Weil-McLain		All	
8	511-330-079	Ignition Control Module	United Technologies	1107-2	All	
9	511-842-370	Control Transformer, 24 V, 40 VA	Honeywell	AT140B-1297	All	
			Basler Electric	BE111640 GDD		
NS	591-391-900	Wire Harness, Power Supply	Weil-McLain		All	
NS	591-391-905	Wire Harness, Spark Ignition	Weil-McLain		All	
NS	510-811-363	Conversion Kit: Natural to Propane CGa 7-8 (Standing Pilot Only)	Weil-McLain			
NS	510-811-356	Conversion Kit: Propane to Natural CGa 25-6 (Standing Pilot Only)	Weil-McLain			
NS	510-811-357	Conversion Kit: Propane to Natural CGa 7-8 (Standing Pilot Only)	Weil-McLain			
NS	510-811-362	Conversion Kit: Natural to Propane CGa-25 - 6 (Standing Pilot Only)	Weil-McLain			