

# Central Brass

MANUFACTURING COMPANY

2950 East 55<sup>th</sup> St. Cleveland, Ohio 44127

Phone: (216) 883-0220 Fax: (216) 883-0875

www.CentralBrass.com

**MODEL NO. 0211-Q**  
**LEG TUB FITTING**

The leg tub fitting has a cast brass body with replaceable seats. The fitting body and spout are polished and chrome plated. The outlet spout is designed for a push on hose connection. The spout fits hose with a 1/2 inch inside diameter. The quarter turn stems are all brass with a double O-Ring seal and acrilonitrile seat washer. The handles are zinc die cast with a chrome plated finish.

ASME A112.18.1M

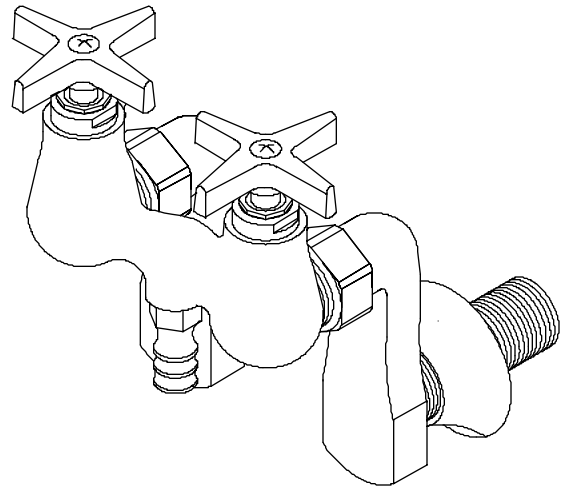

## Installation Drawing

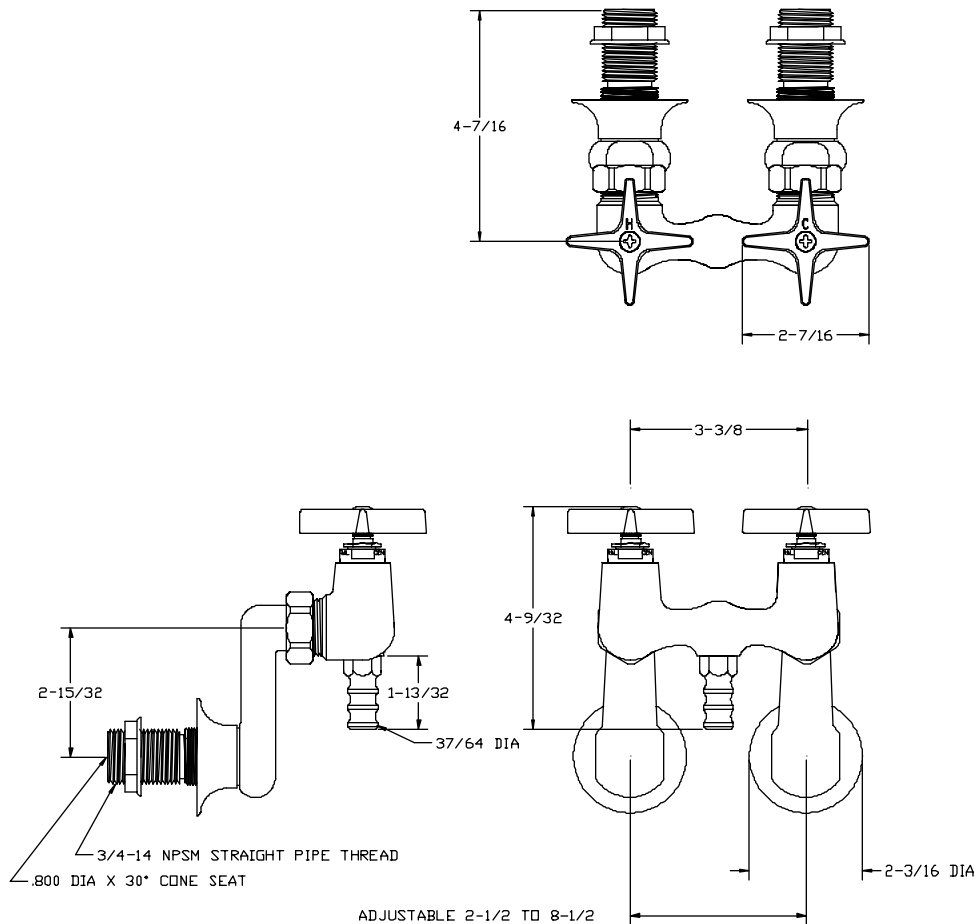

# Central Brass

MANUFACTURING COMPANY

2950 East 55<sup>th</sup> St. Cleveland, Ohio 44127

Phone: (216) 883-0220 Fax: (216) 883-0875

www.CentralBrass.com

**MODEL NO. 0211-Q  
LEG TUB FITTING**

## Parts Breakdown

| #  | Part#       | Description                      |
|----|-------------|----------------------------------|
| 1  | 4090-3/4    | Zinc Locknut                     |
| 2  | 1767-A      | Brass Faucet Body                |
| 3  | 263-BC      | Bronze Seat                      |
| 4  | 1028-Y      | Nylon Gasket                     |
| 5  | 104         | Brass Seat Washer Screw          |
| 6  | 901-WN      | Seat Washer                      |
| 7  | 454-FR      | Brass Right Thread O-Ring Stem   |
| 8  | 1038-453    | O-Ring                           |
| 9  | 454-EH      | Brass Right Thread O-Ring Bonnet |
| 10 | 1045-SCM    | 4 Arm Handle - Indexed "C"       |
| 10 | 1045-SHM    | 4 Arm Handle - Indexed "H"       |
| 11 | 107-F       | Brass Phillips Head Screw        |
| 12 | PF-177-G    | Brass Spout                      |
| 13 | 940-TRN     | Washer                           |
| 14 | PF-256-L    | Brass Spud                       |
| 15 | PF-2843-49  | Brass Hex Spout Nut              |
| 16 | 2841        | Brass Offset Arm                 |
| 17 | 390         | Flange                           |
| 18 | 1768        | Brass Shank                      |
| 19 | SU-454-ERRC | Right Thread Stem Assembly       |

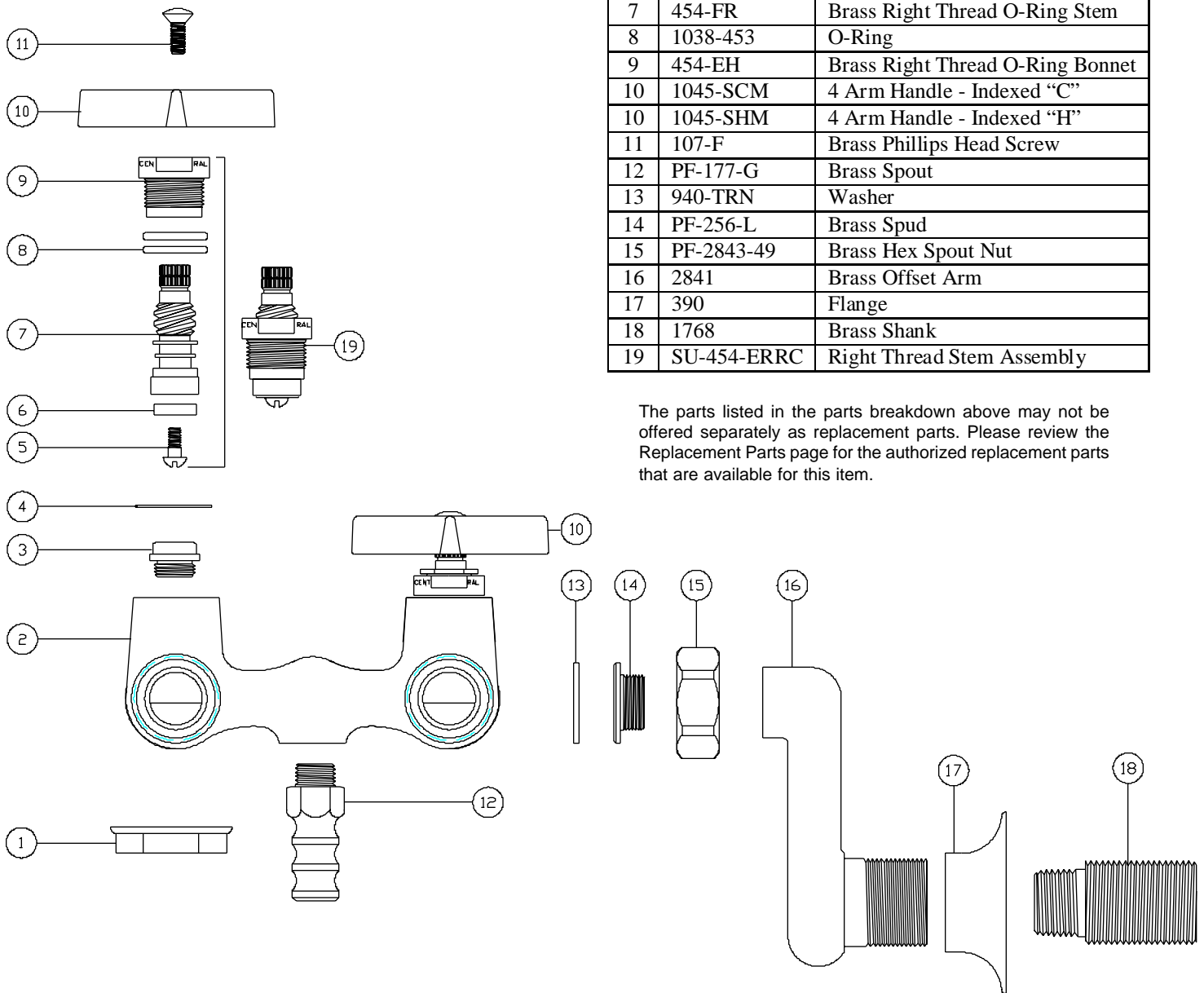

The parts listed in the parts breakdown above may not be offered separately as replacement parts. Please review the Replacement Parts page for the authorized replacement parts that are available for this item.