

ProPEX to MIP lead-free (LF) brass ball valves

Project Information

Job name:	Location:
Engineer:	Date submitted:
Contractor:	Submitted by:
Manufacturer's representative:	Approved by:

Technical data

Material	LF Brass
End type 1	ProPEX 1/2"
End type 2	MNPT 1/2"
Cold working pressure	249.5 psi
Temp/pressure ratings	73 °F (23 °C) at 160 psi (11 bar) 180 °F (82 °C) at 100 psi (6.9 bar) 200 °F (93 °C) at 80 psi (5.5 bar) 210 °F (99 °C) at 149 psi (10.3 bar)
Prop 65 label required?	Yes

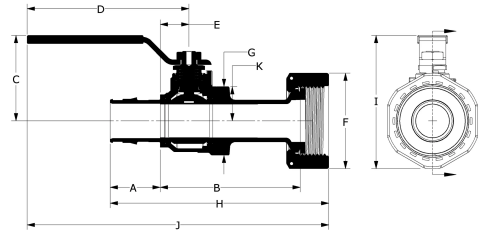

Product information and application use

ProPEX® Lead-free Ball Valve features a shut-off valve between 1/2" Uponor AquaPEX® tubing and 1/2" male iron pipe (MIP). These valves are not compatible with applications using glycol.

Part name	Part no.	A [inch]	B [inch]	C [inch]	D [inch]	E [inch]	F [inch]	G [inch]	H [inch]	I [inch]	J [inch]
ProPEX LF Brass Ball Valve, 1/2" PEX x 1/2" MIP	LF4795050	0.709	1.209	1.157	0.88	0.605	1.155	1	2.459	1.657	2.025

Part name	Part no.	K [inch]	Weight per UOM [lbs/UOM]
ProPEX LF Brass Ball Valve, 1/2" PEX x 1/2" MIP	LF4795050	0.5	0.34

Installation

Install valve according to local building code. Do not dismantle. If soldering, aim flame away from fitting. For more information, refer to the Uponor Professional Plumbing Installation Guide.

Related applications

PEX-a Plumbing Systems

Codes

UPC|IRC|IPC|NPC of Canada

Standards

NSF-372|ASME A112.18.1|ASTM F877|ASTM F1960|CSA B125|CSA B137.5|NSF-61|NSF-14

Listings

cNSFus-pw-G|U.P.Code

Footnotes

Contact information

Uponor Inc.
5925 148th Street West
Apple Valley, MN 55124
T 800.321.4739
F 952.891.2008

Uponor Ltd.
6510 Kennedy Road
Mississauga, ON L5T 2X4
T 888.594.7726
F 800.638.9517