

# ProPEX lead-free (LF) brass residential ball valves

## Project Information

Job name:	Location:
Engineer:	Date submitted:
Contractor:	Submitted by:
Manufacturer's representative:	Approved by:

## Technical data

Material	LF Brass
Manifold size	inch
Temp/pressure ratings	200 °F (93 °C) at 200 psi (13.8 bar)
Prop 65 label required?	Yes

## Product information and application use

To help meet the stringent demands of residential plumbing and hydronic distribution projects, Uponor is offering new ProPEX® ASTM F1960 lead-free (LF) brass ball valves in sizes from ½" to 1". The full-port ball valves feature a chrome-plated ball.

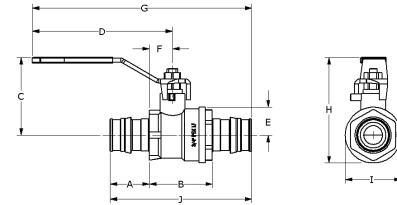

Part name	Part no.	A [inch]	B [inch]	C [inch]	D [inch]	E [inch]	F [inch]	G [inch]	H [inch]	I [inch]	J [inch]
ProPEX LF Brass Stop and Drain Ball Valve (full port), 1" PEX x 1" PEX	LFD4811010	1.181	1.862	1.978	4.227	0.746	0.909	6.361	2.724	2.022	4.224
ProPEX LF Brass Stop and Drain Ball Valve (full port), 1/2" PEX x 1/2" PEX	LFD4815050	0.709	1.449	2.867	3.681	1.624	0.725	5.114	2.071	1.437	2.867
ProPEX LF Brass Stop and Drain Ball Valve (full port), 3/4" PEX x 3/4" PEX	LFD4817575	0.945	1.657	1.841	4.241	0.602	0.803	6.04	2.443	1.726	3.548
ProPEX LF Brass Ball Valve (full port), 1" PEX x 1" PEX	LFR4811010	1.181	1.618	2.208	4.503	0.746	0.685	6.617	2.954	1.492	3.98
ProPEX LF Brass Ball Valve (full port), 1/2" PEX x 1/2" PEX	LFR4815050	0.709	1.228	1.647	3.361	0.447	0.465	4.834	2.094	0.939	2.646
ProPEX LF Brass Ball Valve (full port), 3/4" PEX x 3/4" PEX	LFR4817575	0.945	1.357	1.796	3.361	0.634	0.522	5.142	2.43	1.268	3.247

Part name	Part no.	Cv	Cv Through	Weight per UOM [lbs/UOM]	End Type 1	End Type 2
ProPEX LF Brass Stop and Drain Ball Valve (full port), 1" PEX x 1" PEX	LFD4811010	31.7	-	0.9	ProPEX 1"	ProPEX 1"
ProPEX LF Brass Stop and Drain Ball Valve (full port), 1/2" PEX x 1/2" PEX	LFD4815050	6.5	-	0.35	ProPEX 1/2"	ProPEX 1/2"
ProPEX LF Brass Stop and Drain Ball Valve (full port), 3/4" PEX x 3/4" PEX	LFD4817575	16.6	-	0.6	ProPEX 3/4"	ProPEX 3/4"
ProPEX LF Brass Ball Valve (full port), 1" PEX x 1" PEX	LFR4811010	31.4	-	0.88	ProPEX 1"	ProPEX 1"
ProPEX LF Brass Ball Valve (full port), 1/2" PEX x 1/2" PEX	LFR4815050	6.7	-	0.34	ProPEX 1/2"	ProPEX 1/2"
ProPEX LF Brass Ball Valve (full port), 3/4" PEX x 3/4" PEX	LFR4817575	15.8	-	0.5	ProPEX 3/4"	ProPEX 3/4"

## Installation

Install valve and stem extension kit according to local building code. Do not dismantle. Refer to the Uponor Piping Pocket Guide or the Uponor Plumbing Design Assistance Manual (PDAM) for additional information.

## Related applications

- Hot water distribution
- Hydronic heating and cooling systems
- Hydronic Piping Systems
- Hydronic Radiant Heating and Cooling Systems
- PEX-a Plumbing Systems
- Plumbing Systems
- Pre-Insulated Pipe Systems
- Radiant Heating and Cooling Systems

Codes	Standards	Listings
UPC IBC IRC IPC NPC of Canada UMC IMC	NSF-372 ASTM F877 NSF-359 ASTM F1960 CSA B137.5 NSF-61 NSF-14	cNSFus-pw-G U.P.Code

Footnotes	Contact information	
-	<p>Uponor Inc.  5925 148th Street West  Apple Valley, MN 55124  T 800.321.4739  F 952.891.2008</p>	<p>Uponor Ltd.  6510 Kennedy Road  Mississauga, ON L5T 2X4  T 888.594.7726  F 800.638.9517</p>