



TITAN™

Composite Well Tanks



Tougher Outside. Better Inside.™



TITAN™



Amtrol has been the leader in pre-pressurized well tanks for nearly 60 years and the Amtrol Titan™ composite well tank represents the latest addition. Like all Amtrol products, the Amtrol Titan has gone through extensive testing and is proven to provide a strong, tough, reliable solution for water system applications.

The new Amtrol Titan with its patented design, combines the strength of steel and the advantages of high tech composite materials. On the outside, the resilient, deeply textured composite fiber provides superior impact resistance with UV protection. Inside the tank, the spin welded domes and inner extruded core along with the only fixed diaphragm on the market, sets a new standard for design excellence. Amtrol Titan Composite Well Tanks – Tougher on the Outside, Better on the Inside™.

Connector Design Withstands the Rigors of the Industry.

- PVC Schedule 80 pipe withstands aggressive water conditions.
- Stable elbow connection.
- Assembly ensures proper seal compression.

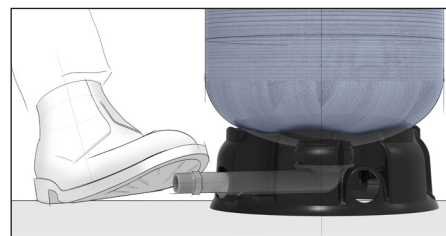

Tougher on the Outside. Better on the Inside.™

Hoop and Groove Design

- The only fixed diaphragm composite well tank on the market.
- Strong steel outer band encircles the core to lock the diaphragm assembly securely together.
- Same diaphragm attachment method used on all Amtrol well tanks.
- The Industry's Standard of Excellence.

Inner Core and Domes

- Strong, lightweight polypropylene core and durable co-polymer domes serve as the water reservoir for the tank.
- Inner core unifies the seal between the diaphragm and core.
- Spin welded domes fortify the connection to inner core providing a rigid construction.
- Insert molded, glass fiber-reinforced connector enhances strength.

Outer Composite Shell

- Strong epoxy infused glass fiber winding can withstand the harshest conditions.
- Resilient outer surface delivers UV protection.
- Rugged exterior shell provides outstanding durability.
- Glass fiber winding does not corrode in damp environments.

The Amtrol Titan's fixed diaphragm design and rigid spin welded domes/polypropylene core construction represents the new standard of excellence.

Strong steel band encircles the inner polypropylene core for strong reinforcement and seals the inner hoop and diaphragm in place.

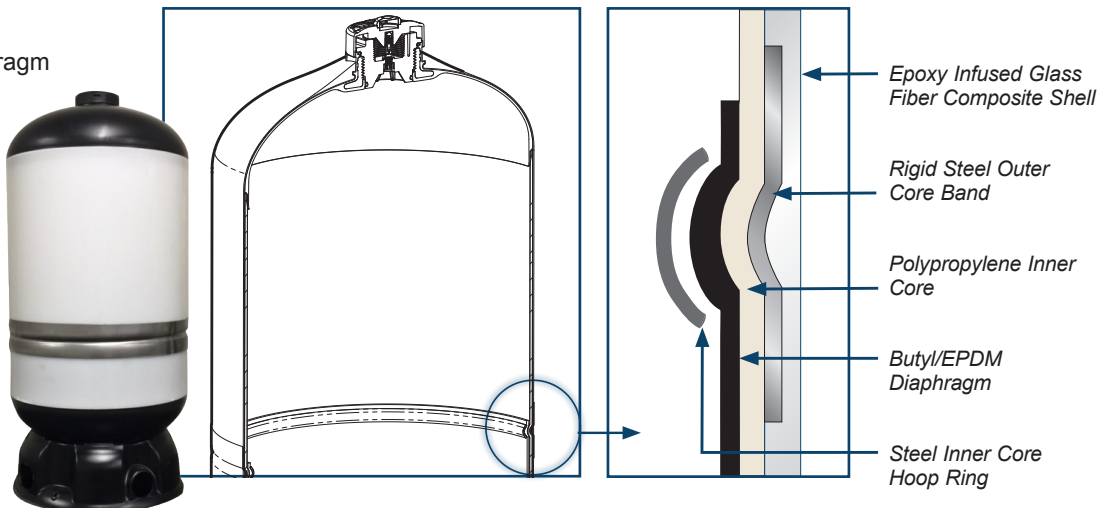

Fixed Diaphragm Composite Well Tanks

Connection Seal Design

- Dual O-ring design with radial and face seal to prevent leaks.
- EPDM - Minimizes leak paths.

Copolymer Domes

- Strong, durable co-polymer material.



Inner Extruded Core

- Polypropylene.
- Strong, durable, and NSF approved.



Protective Air Stem

- Provides full protection and easy access for pre-charge.
- Corrosion resistant.



Outer Composite Shell

- Epoxy infused glass fiber wrapping.
- Impact resistant.
- Durable and tough coating.

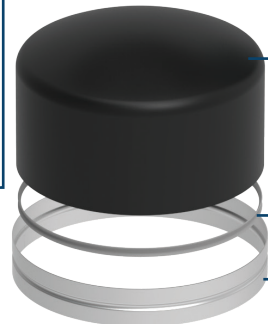
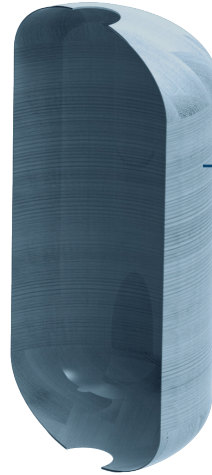

Fixed Diaphragm Design

- Heavy-duty diaphragm with Butyl/EPDM material.
- Seamless design conforms to the inner poly core creating seal.
- Unique inner hoop and reinforced steel outer core band lock seal into place.
- Only one in the market, utilizing proven Amtrol Fixed Diaphragm Technology.



Reinforced Tank Connection

- Fortified connector enhances strength and exceeds industry standards.
- Strong, durable and NSF approved.

Durable Copolymer Stand

- Composite design provides impact resistance and superior support.
- The rugged material is UV and corrosion resistant.



Patented Turbulator®

- Unique design directs incoming water.
- Water-jet action prevents sediment buildup that can cause diaphragm abrasion.
- Helps extend the life of the tank.

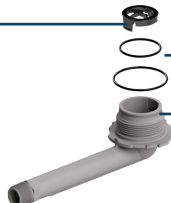

Connection Seal Design

- Dual O-ring design with radial and face seal to prevent leaks.
- EPDM - Minimizes leak paths.

Robust Elbow Connector

- Ratchet design creates a strong connection.
- Withstands the rigors of the industry.
- Patent pending connector design.

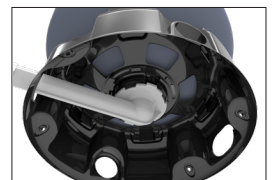

Design ensures strong connection integrity.



Specifications



Amtrol TITAN™ Composite Models

- Strength of steel with the advantages of high tech composite materials.
- Only fixed diaphragm composite well tank on the market with a patented design.
- Deep textured epoxy infused glass fiber wrapping provides superior impact resistance.
- Protected air stem for easy access and corrosion resistance.
- 5-Year limited warranty.

TC Models

Model Number	Tank Volume (Gallons)	Max. Acceptance Factor	Diameter (Inches)	Height (Inches)	System Connection NPTM (Inches)	System Drawdown (Gallons)			Weight (lbs.)
						30/50	40/60	50/70	
TC-20	20.0	.57	15	35	1	6.2	5.4	4.7	27
TC-32	32.0	.35	15	50	1	9.9	8.6	7.6	35

PVC System Connection. Center of Water Inlet to Bottom of Tank (Inches)= 1.75"
 Maximum Operating Temperature: 120°F. Factory Pre-Charge: 38 PSI. Maximum Working Pressure: 125 PSI



1400 Division Road, West Warwick, RI 02893 USA
 T: 800.426.8765 www.amtrol.com

