

The Best Products, The Best Service...

SERVICE METAL

ONE CALL GETS IT ALL



Caps EXTRA STRONG Inches / Pounds

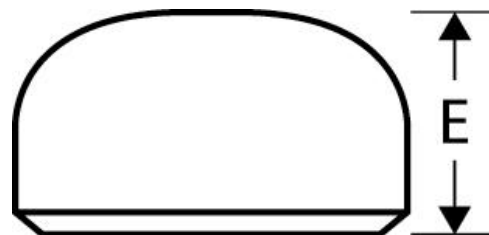

Nominal Pipe Size	Outside Diameter	Inside Diameter	Wall Thickness	Length (E)	Pipe Schedule	Approximate Weight (in Pounds)
1/2	.84	.546	.147	1.00	80	.1
3/4	1.050	.742	.154	1.25	80	.16
1	1.315	.957	.179	1.50	80	.28
1 1/4	1.660	1.278	.191	1.50	80	.48
1 1/2	1.900	1.500	.200	1.50	80	.67
2	2.375	1.939	.218	1.50	80	.92
2 1/2	2.875	2.323	.276	1.50	80	1.3
3	3.500	2.900	.300	2.00	80	2.1
3 1/2	4.000	3.364	.318	2.50	80	3
4	4.500	3.826	.337	2.50	80	3.5
5	5.563	4.813	.375	3.00	80	5.8
6	6.625	5.761	.432	3.50	80	9.3
8	8.625	7.625	.500	4.00	80	16
10	10.75	9.750	.500	5.00	60	26
12	12.75	11.75	.500	6.00	XS*	38
14	14.00	13.00	.500	6.50	XS*	47
16	16.00	15.00	.500	7.00	40	57
18	18.00	17.00	.500	8.00	XS*	78
20	20.00	19.00	.500	9.00	30	100
22	22.00	21.00	.500	10.00	XS*	115
24	24.00	23.00	.500	10.50	XS*	145
26	26.00	25.00	.500	10.50	XS*	175
30	30.00	29.00	.500	10.50	20	634
34	34.00	33.00	.500	10.50	XS*	210
36	36.00	35.00	.500	10.50	20	913
42	42.00	41.00	.500	12.00	XS*	1,300
48	48.00	47.00	.500	13.50	XS*	1,675

* XS* designates Extra Strong (extra strong wall). This size and thickness does not correspond to any pipe schedule number.

* Dimensions conform to ASME B16.9 & material conforms to ASTM SA-234 Grade B.