

**SUBMITTAL SHEET**

JOB NAME	ITEM TAG
JOB LOCATION	PART NUMBER
CONTRACTOR	DATE
ENGINEER APPROVAL	DATE

**PACK JOINT COUPLING X MIP COUPLING I.P.S. X M.I.P.**

**Model T-4320**

Manufactured to AWWA specifications  
C800 specifications  
Designed for use as an underground water service fittings.

**Working Pressure, Non Shock (PSI)**  
Cold working pressure (CWP): 100 PSI 3/4"-1" ,80 PSI 1 1/4"- 2"

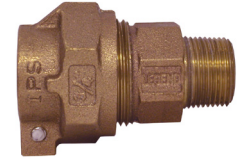

*Pictured*  
**Model T-4320**

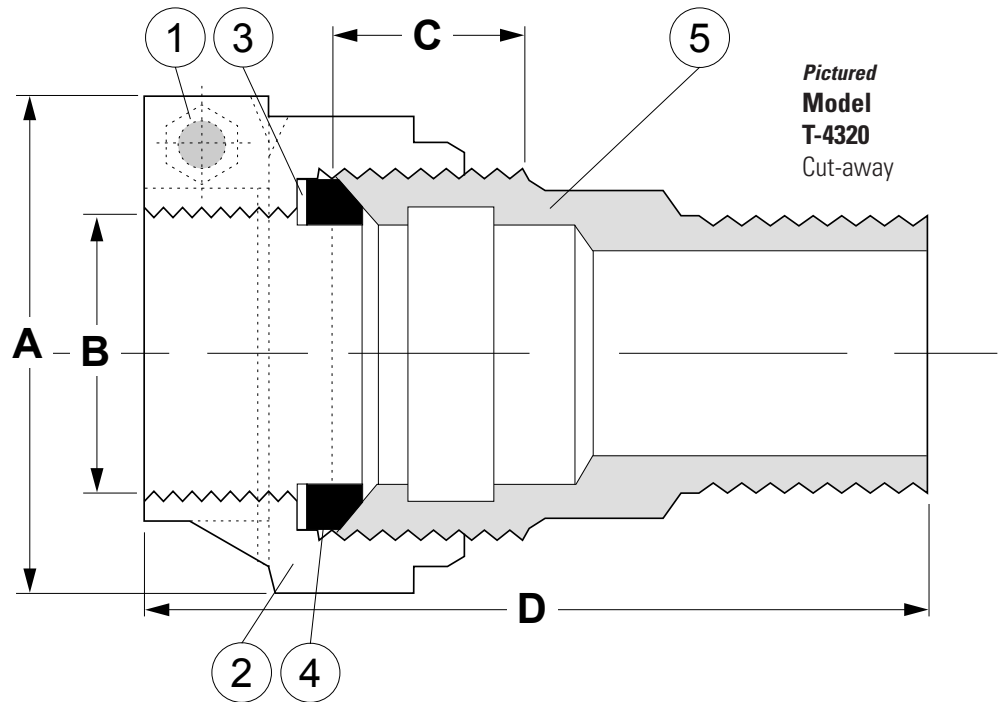

<b>MATERIAL SPECIFICATION</b>			
PART	MATERIAL	SPECIFICATION	
1	Split clamp screw	Stainless steel	ASI GRADE 304
2	I.P.S. Nut	Bronze	ASTM B62 UNS C83600
3	Anti-friction ring	Nylon	Commercial grade
4	Gasket	Buna-n	Commercial grade
5	Body	Bronze	ASTM B62 UNS C83600/C89836

<b>DIMENSIONS</b>				
Size	A	B	C	D
3/4"	2.25	1.10	.37	3.20
1"	2.85	1.40	.70	3.74
3/4" X 1"	2.25	1.10	.37	3.31