

A BIS Metal Pipe Clamps with Lining

BISMAT[®] 2000

for metal pipes \varnothing 1/4 - 2"

3/8"

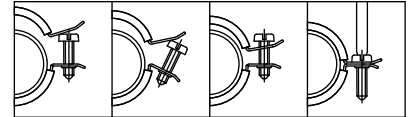

Features and benefits

- single screw clamp
- with BISMAT[®] quick locking system
- clamp easy to close with one hand
- material: steel
- zinc plated
- noise insulating lining, EPDM rubber, black
- age resistant lining
- sound insulating lining according DIN 4109
- tested for fire safety
- complies with Federal Specification WW-H-w171E and A-A-1192A Type 4 and Manufacturers Standardization Society MSS SP-58 and SP-69 type 12
- Plenum rated - tested to ASTM E-84

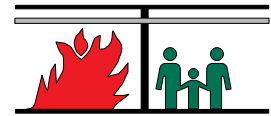

Part No.	D (mm)	IP (")	CT (")	G (")	B (")	H (")	h (")	b x s (mm)	Fa,z (lbs)	Pack 1
CR 341 9 014	11 - 14	1/4	3/8	3/8"	1.9	1.4	0.87	20 x 1.25	47	50
CR 341 9 018	15 - 18	3/8	1/2	3/8"	1.9	1.4	0.87	20 x 1.25	47	50
CR 341 9 023	20 - 23	1/2	3/4	3/8"	2.2	1.6	0.94	20 x 1.25	47	50
CR 341 9 028	25 - 28	3/4	1	3/8"	2.4	1.8	1.10	20 x 1.25	47	50
CR 341 9 035	31 - 35	1	1 1/4	3/8"	2.6	2.0	1.20	20 x 1.25	47	50
CR 341 9 043	40 - 43	1 1/4	1 1/2	3/8"	3.0	2.4	1.30	20 x 1.25	67	50
CR 341 9 053	48 - 53	1 1/2	-	3/8"	3.3	2.6	1.50	20 x 1.50	67	50
CR 341 9 054	54 - 56	-	2	3/8"	3.5	2.8	1.60	20 x 1.50	67	50
CR 341 9 063	57 - 63	2	-	3/8"	3.7	3.1	1.70	20 x 1.50	67	50

The max. allowed load (Fa,z) is calculated using specific statistical methods related to the breaking load, taking into account a deflection to 1,5 mm or 2% of the maximum nominal clamp diameter. Up to and including \varnothing 63 mm tested for fire safety.

