

# Plastic bend supports

## Project Information

Job name:	Location:
Engineer:	Date submitted:
Contractor:	Submitted by:
Manufacturer's representative:	Approved by:

## Technical data

Material Plastic

## Product information and application use

Plastic Bend Support (glass-reinforced nylon) provides rigid 90-degree bend and sleeve for 3/8", 1/2" and 3/4" Uponor PEX tubing.

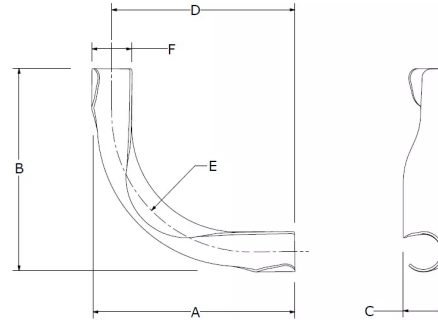

Part name	Part no.	A [inch]	B [inch]	C [inch]	D [inch]	E [inch]	F [inch]	Weight per UOM [lbs/UOM]
3/8" Plastic Bend Support	A5150375	3.866	4.071	1.025	3.448	2.475	1.025	0.05
3/4" Plastic Bend Support	A5150750	6.109	6.11	1.225	5.517	3.84	1.185	0.15
1/2" Plastic Bend Support	A5250500	3.644	3.646	0.52	3.125	2.385	0.52	0.05
1/2" Plastic Bend Support (not for use with Wall Support Bracket A5750500)	A5150500	4.062	4.062	0.99	3.5	2.341	0.99	0.05

## Installation

Snap the tubing into the Bend Support at the beginning of the bend. Continue the bend through the support and snap the tubing into the support at the end of the bend as well. Refer to the AQUAPEX® Professional Plumbing Installation Handbook or Uponor Radiant Installation Handbook for additional information.

## Related applications

- PEX-a Plumbing Systems
- Fire Safety Systems
- Hydronic Distribution Systems
- Radiant Heating and Cooling Systems

## Codes

## Standards

## Listings

## Footnotes

## Contact information

Uponor Inc.  
5925 148th Street West  
Apple Valley, MN 55124  
T 800.321.4739  
F 952.891.2008

Uponor Ltd.  
6510 Kennedy Road  
Mississauga, ON L5T 2X4  
T 888.594.7726  
F 800.638.9517