

“QUALITY PUMPS SINCE 1939”

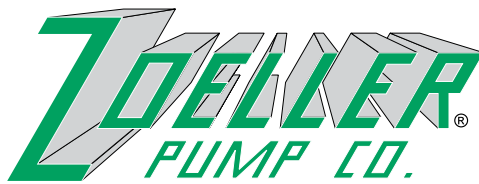

SECTION: 2.50.010

FM1478

1006

Supersedes

0405

Product information presented here reflects conditions at time of publication. Consult factory regarding discrepancies or inconsistencies.

MAIL TO: P.O. BOX 16347 • Louisville, KY 40256-0347  
SHIP TO: 3649 Cane Run Road • Louisville, KY 40211-1961  
(502) 778-2731 • 1 (800) 928-PUMP • FAX (502) 774-3624

visit our web site:  
[www.zoeller.com](http://www.zoeller.com)

# THE SHARK Series 820 GRINDER PUMP

## FEATURES:

- Automatic with Integral Control, Nonautomatic available.
- UL Listed.
- Durable Heavy Duty Finned Cast Iron Construction.
- Legs provide for free standing installation.
- Motor - 2 HP, 60 Hz, 3450 RPM, Oil-filled, Hermetically Sealed with Class B Insulation, Automatic Reset Thermal Overload Protected.
- Upper and Lower Ball Bearings Running in Bath of Oil.
- Hardened Stainless Steel Cutter and Disc.
- Cutters Protected from Abrasive Solids.
- Stainless Steel Lifting Handle, Screws, and Bolts.
- Easily adapts to Rail Systems.
- Mechanical Shaft Seal - Carbon/Ceramic.
- Control panels are not required.
- Simplex Grinder Package Systems (Unassembled and Job Ready/Assembled) available.
- Corrosion resistant powder coated epoxy finish.
- Maximum operating temperature 130°F (54°C).
- 20' Power Cord.

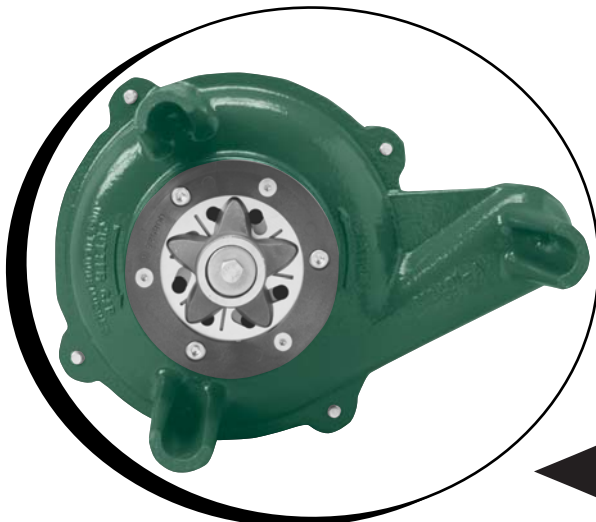

**UNIQUELY DESIGNED PUMP WITH INTEGRAL CONTROL**  
(For Pump Prefix Identification see News & Views 0052)



Tested to UL Standard UL778



**WD820/WH820  
AUTOMATIC**



**E820/I820  
NONAUTOMATIC**



Product may not be exactly as pictured.

# PREPACKAGED AND JOB READY SYSTEMS

INDOOR		
<b>REQ.</b>		
1 Grinder (Auto or Nonauto)	P/N _____	(A)
1 Alarm System (Optional)	P/N _____	(B)
1 Weight Only (Required if alarm is used)	P/N 10-0689	(C)
1 Junction Box (Optional)	P/N 10-0666	(E)
1 Basin, Cover and Hardware	P/N _____	(F)

OUTDOOR		
<b>REQ.</b>		
1 Grinder (Auto or Nonauto)	P/N _____	(A)
1 Control Panel/Alarm System	P/N _____	(B)
1 Float Switch/es (if required)	P/N _____	(C)
1 Weight/s and Bracket/s	P/N _____	(C)
1 Junction Box	P/N _____	(E)
1 Basin, Cover and Rail System	P/N _____	(G)

## FIELD MOUNT SYSTEMS

SIMPLEX		
<b>REQ.</b>		
1 Grinder (Auto or Nonauto)	P/N _____	(A)
1 Alarm System (Optional)	P/N _____	(B)
1 Variable Level Fl. Sw. Assm. <sup>(2)</sup> (Not required for auto pumps)	P/N _____	(C)
1 Weight and Bracket Only (2 required if alarm is used)	P/N 10-0661	(C)
1 Junction Box (Optional)	P/N _____	(E)
1 Rail System (Optional)	P/N _____	(H)
1 Angle Arm/Intermediate Bracket <sup>(1)</sup>	P/N _____	(H)
1 Pull Rod <sup>(3)</sup>	P/N _____	(J)
1 S.S. Cable	P/N _____	(K)

<sup>(1)</sup> Required for basins over 72" deep (Square Guide Rail) and over 12" (E-Z Out Rail). Allow for overhead clearances.

<sup>(2)</sup> Hardwire pump, float switch, and power supply inside junction box.

<sup>(3)</sup> For Square Guide Rail Only

**Note:** Contact factory for control panel selection.

**Note:** Access Doors Available on Field Mount Systems - Consult Factory  
Special Basin Configurations - Consult Factory

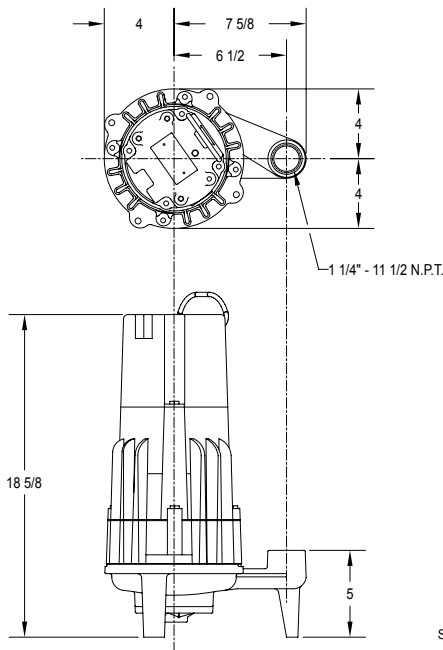
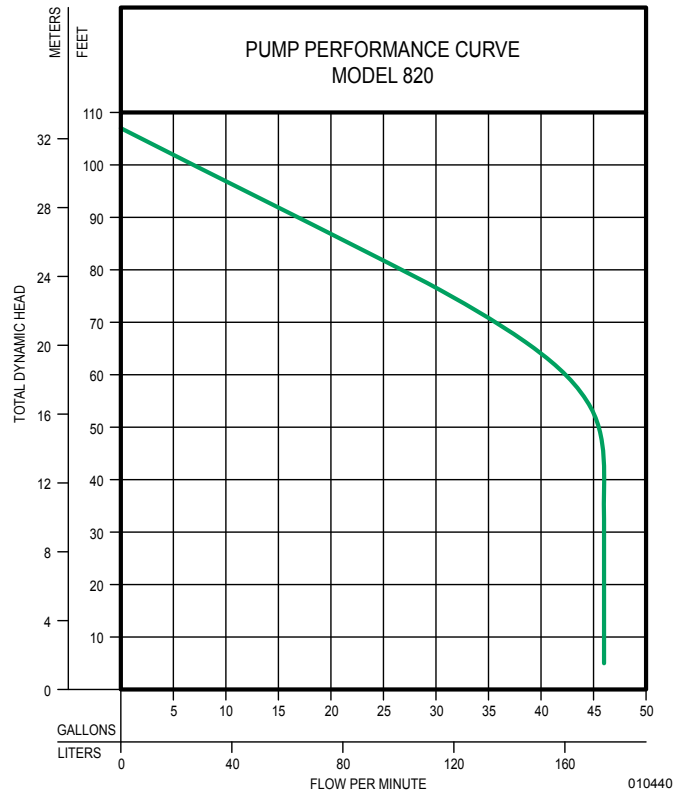

SK1621

Manufacturers of... **"QUALITY PUMPS SINCE 1939"**