

SERVICE KIT INSTRUCTIONS

INSTALL THE SHROUD

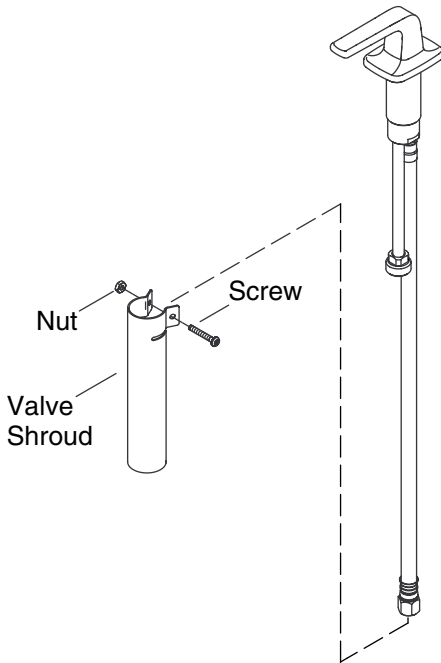

NOTICE: Risk of product damage. Hose should not contact or rub on the edges of the valve shroud.

- Move the valve shroud around the tube and hose.
- Slide the valve shroud up until it reaches the underside of the valve body.
- Pinch the tabs on the valve shroud together until they are parallel with one another.
- Insert the panhead screw through the holes in both tabs of the valve shroud.
- Thread the nut onto the screw and tighten into place. **Do not overtighten.**
- Repeat with the other valve and shroud.