

Central Brass Company, Inc.

3325 S. Garfield Ave.
Commerce, CA 90040
(800) 321-8630
www.centralbrass.com

Model Number: 1130

Warnings and Notes:

Check with local plumbing code requirements before installation.
This product should be installed by a local listed plumber.

Do not use plumbers putty on threads.

Installation Steps:

Single Handle Shampoo Fitting

INSTALLATION

Tools:



Adjustable Wrench



Plumbers Putty



Teflon Tape



Rags

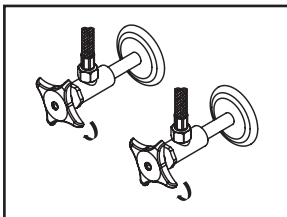

(1) Shut off water supplies. Remove old faucet. Clean mounting surface in preparation for new faucet.

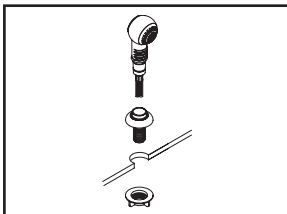

(2) Place hose guide in position of mounting hole, secure hose guide by tightening locknut from underneath the sink.

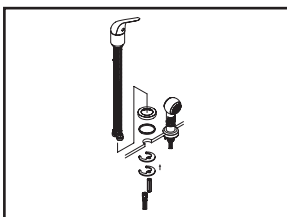

(3) Thread and tighten mounting bolt to the bottom of side valve, place escutcheon with washer under the side valve, insert side valve through mounting hole. Slide mounting washers to the mounting bolt and tighten mounting nut to mounting bolt from underneath the sink. Connect end connection of hose to the spray head port from underneath of the mounting surface.

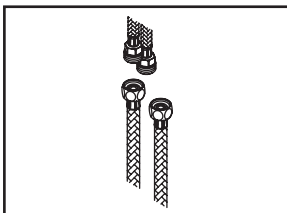

(4) when using stainless steel braided faucet supply hose; this faucet requires one end of the supply hose to have a 1/2" female IPS connection. The other end of this supply hose must match the thread on the water supply valve under your sink. Once you've identified the required size, carefully follow the manufacturer's installation instructions for each hose.