

Central Brass Company, Inc.
3325 S. Garfield Ave.
Commerce, CA 90040
(800) 321-8630
www.centralbrass.com

Tools:



Adjustable Wrench



Plumbers Putty



Teflon Tape



Rags

Model Number: 0255 Series

Warnings and Notes:

Check with local plumbing code requirements before installation.
This product should be installed by a local listed plumber.
Do not use plumbers putty on threads.



Installation Steps:

Self-Close Single Handle Basin Faucet

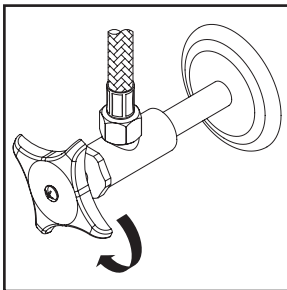

(1) Shut off water supply. Remove old faucet. Clean mounting surface in preparation for new faucet.

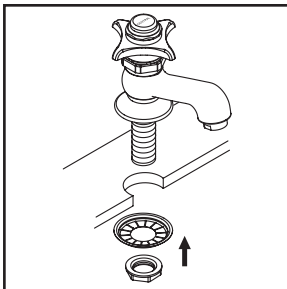

(2) Apply a layer of plumbers putty to underside of faucet, place faucet shank through the mounting hole. Slide the crown foot washer through shank from underneath of the sink. Tighten the locknut with the help of a 1-3/32" socket.

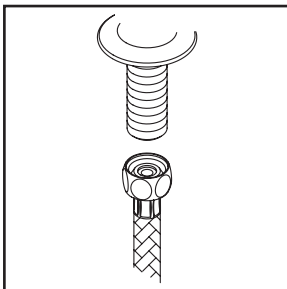

(3) When using stainless steel braided faucet supply hose; this faucet requires on end of the supply hose to have 1/2" female IPS connection. The other end of this supply hose must match the thread on the water supply valve under the sink. Once you've identified the required size, carefully follow the manufacturer's installation instruction to install hose.

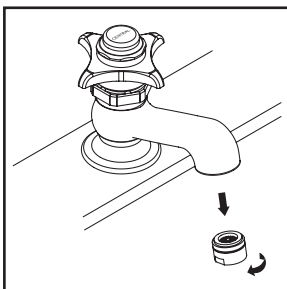

(4) Important: For model# 0255-AX, after installation is complete, remove aerator. Turn on water supply and turn on handle to allow water to run at least one minute. While water is running, check for leaks. Turn off handle and replace aerator.

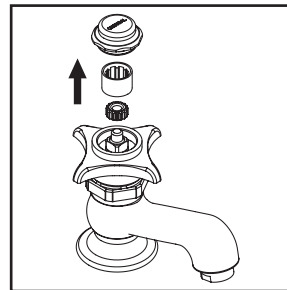

(5) The self-close basin faucet was preset @60 PSI to shut off water, different water pressure might affect the faucet and cause it not to function properly, if need be, remove the handle cap, sleeve and Celcon Samson nut.

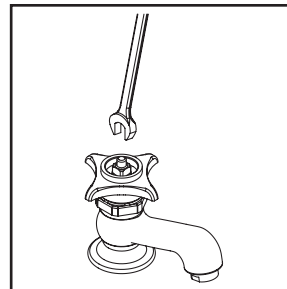

(6) Use wrench to adjust brass square nut, turn counterclockwise to tighten the cartridge and turn it clockwise to loosen the cartridge until the faucet functions properly then proceed to tighten the cartridge 90° more before reassembling the Celcon Samson nut, sleeve, and handle cap back in place.