

## M5SB “B” Cabinet Oil Furnace - A2L Retrofit Kit

### INSTALLATION INSTRUCTIONS

#### Downflow, Direct Vent (Sealed Combustion) Forced Air Oil Furnaces

**Note:** These instructions are to be followed along with the proper removal/installation of a compatible coil. Consult the coil installation instructions for more details.

#### WARNING / AVERTISSEMENT

##### FIRE OR EXPLOSION HAZARD

- Failure to follow safety warnings exactly could result in serious injury, death or property damage.
- Installation and service must be performed by a qualified installer, service agency or the gas supplier.
- Do not store or use gasoline or other flammable vapors and liquids in the vicinity of this or any other appliance.

##### RISQUE D'INCENDIE OU D'EXPLOSION

- Le non-respect des avertissements de sécurité pourrait entraîner des blessures graves ou des dommages matériels importants.
- L'installation et l'entretien doivent être effectués par un installateur qualifié, un organisme de service ou le fournisseur de gaz.
- N'entreposez pas ni n'utilisez de l'essence ni d'autres vapeurs ou liquides inflammables dans le voisinage de cet appareil, ni de tout autre appareil.

##### WHAT TO DO IF YOU SMELL GAS

- Do not try to light any appliance.
- Do not touch any electrical switch; do not use any phone in your building.
- Leave the building immediately.
- Immediately call your gas supplier from a neighbors phone. Follow the gas suppliers instructions.
- If you cannot reach your gas supplier, call the fire department.

##### QUE FAIRE S'IL Y A UNE ODEUR DE GAZ

- N'essayez d'allumer aucun appareil.
- Ne touchez à aucun interrupteur électrique; n'utilisez aucun téléphone dans le bâtiment.
- Évacuez l'immeuble immédiatement.
- Appelez immédiatement le fournisseur de gaz en employant le téléphone d'un voisin. Respectez les instructions du fournisseur de gaz.

**DO NOT DESTROY. PLEASE READ CAREFULLY & KEEP IN A SAFE PLACE FOR FUTURE REFERENCE.**

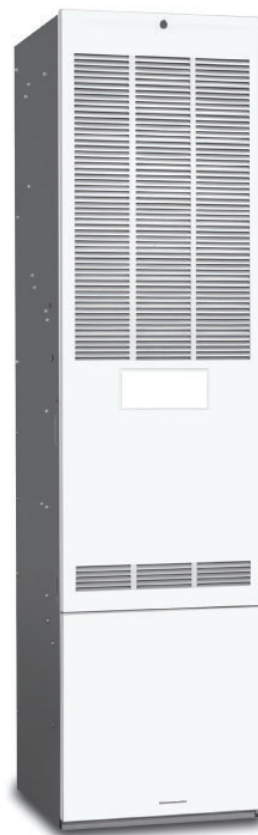

**M5SB “B” CABINET**

#### ATTENTION INSTALLERS:

It is your responsibility to know this product better than your customer. This includes being able to install the product according to strict safety guidelines and instructing the customer on how to operate and maintain the equipment for the life of the product. Safety should always be the deciding factor when installing this product and using common sense plays an important role as well. Pay attention to all safety warnings and any other special notes highlighted in the manual. Improper installation of the Appliance or failure to follow safety warnings could result in serious injury, death, or property damage.

These instructions are primarily intended to assist qualified individuals experienced in the proper installation of this appliance. Some local codes require licensed installation/service personnel for this type of equipment. Please read all instructions carefully before starting the installation. Return these instructions to the customer's package for future reference.

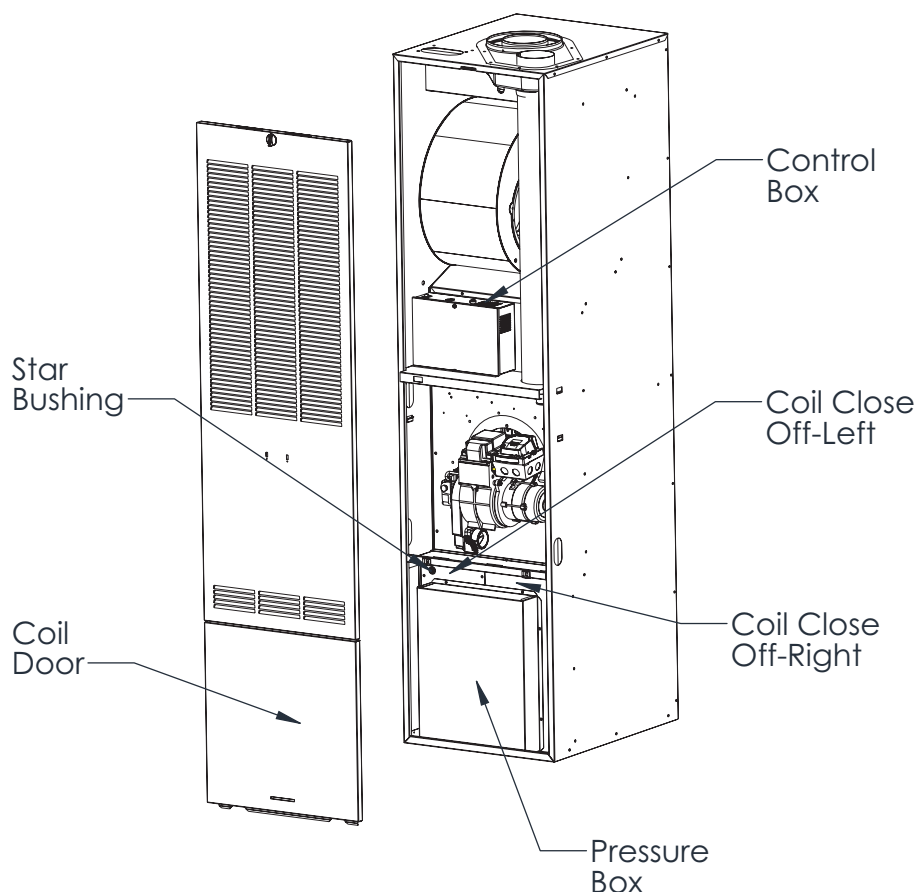

**Figure 1. M5SB "B" Cabinet Part List**

To make M5SB models built before August 2024 compatible with A2L refrigerant and to be able to use a C85 R454B indoor coil with them, this retrofit kit is provided. Before installing a C85 A2L indoor coil please read the C85 installation instructions carefully.

In this kit you have the following parts (Figure 1):

1. Control Box
2. Cutout Template
3. Coil Close Off - Left
4. Coil Close Off - Right
5. Star Bushing
6. Pressure Box
7. Gasketing
8. Coil Door
9. Retrofitted Label

**Follow these steps to make the furnace A2L compatible:**

1. Disconnect all power to the unit.
2. Remove the top door.
3. Remove the bottom coil door.

**Replace Control Box (see Figure 2)**

1. Remove the control box cover.
2. Disconnect all wiring that is routed through the control box.
3. Remove the switch, plug, and grommets from the

- existing control box to install into the replacement box.
4. Unscrew the control box to remove it from the unit.
5. Use the fasteners provided to install the new control box.
6. Re-assemble the switch, plug, and grommets.
7. Re-route and connect the wiring according to the wiring diagram.
8. Leave the control cover off to complete the next step.

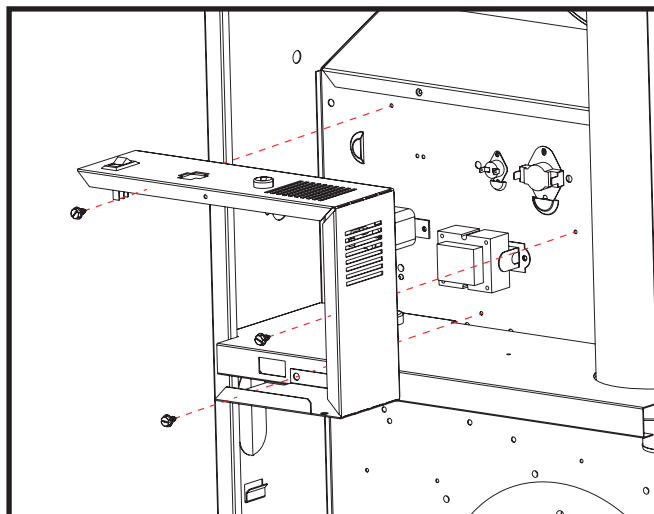

**Figure 2. Control Box Installation**

### Create Ventilation Holes in Control Cover (see Figure 3)

1. Drill a minimum of eight 1/4" diameter vent holes in the control box cover (see suggestions for potential locations in Figure 3).
2. Verify holes are not blocked by any of the control box flanges.
3. Verify the holes avoid existing labels on the front and back of the cover.
2. Re-install the control cover.

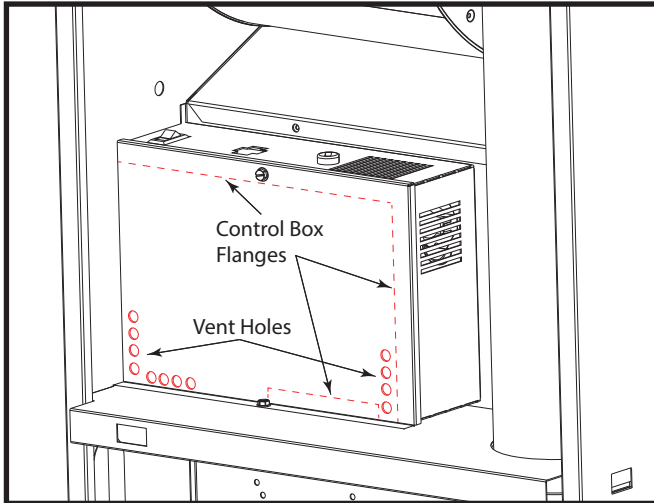

Figure 3. Vent Plate for Control Cover

### Install New Coil Close Off Panels (see Figure 4)

1. Remove existing coil close off panels.
2. Install the new coil close off - right first with the fasteners provided.
3. Next, install the new coil close off - left with the fasteners provided.
4. Install star bushing in the 3/4" hole in the top left corner of the left panel.
5. Verify all screws are tightened and panels are secure.

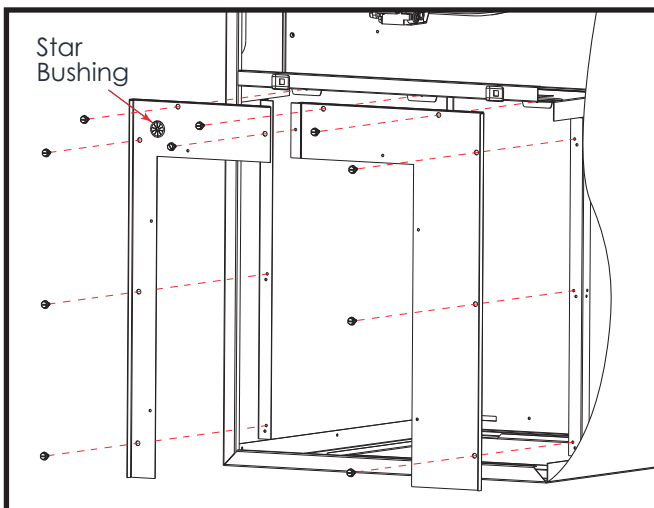

Figure 4. Coil Close Off Panels

### Modify Bottom Pan Drain/Line Set Slot (see Figure 5)

1. Use template 1048996 to modify the slot location on the bottom pan.
2. Verify the newly created slot is inside the pressure box area.

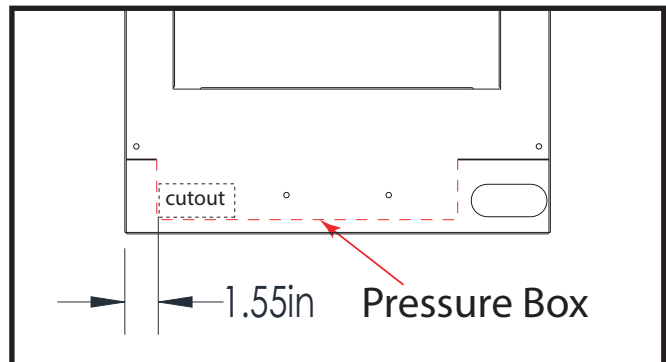

Figure 5. Bottom Pan Modification (Top View)

### Install Pressure Box (see Figure 7)

1. Add gasketing to the bottom side flange of the pressure box to insure a proper seal. (see Figure 6)
2. Install pressure box in cabinet as shown.
3. Verify the bottom edge with gasket has a tight seal.

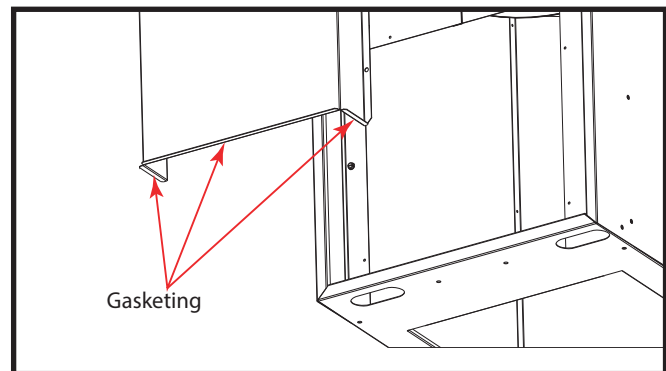

Figure 6. Pressure Box Gasketing

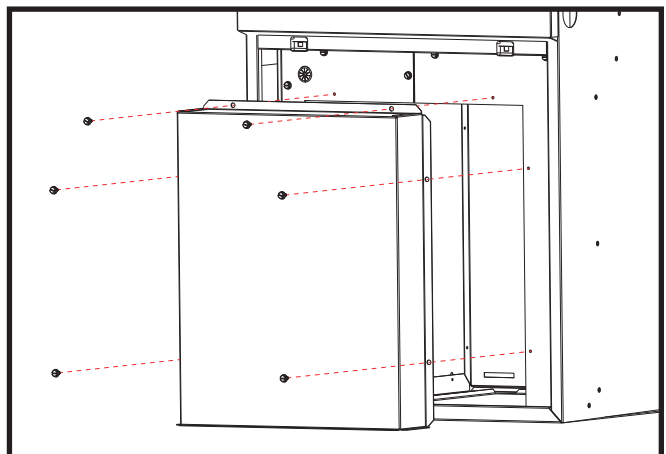
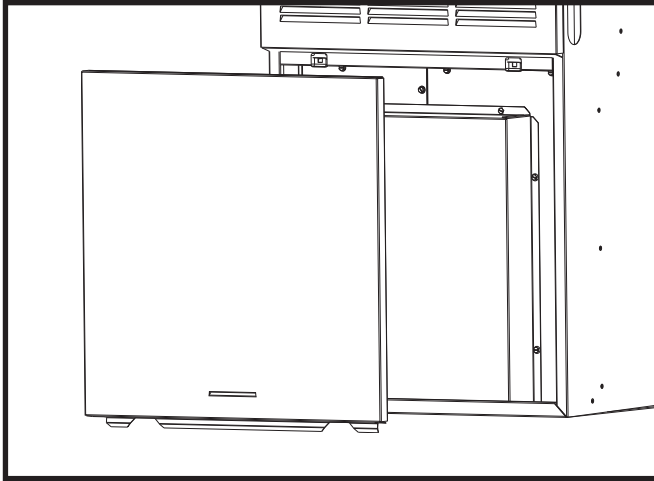

Figure 7. Pressure Box

**Install New Coil Door (see Figure 8)**

1. Install new coil door.
2. Verify that the coil door installed has the vent at the bottom of the door.



**Figure 8. Coil Door**

**Apply Retrofitted Label**

1. Verify all modifications are complete.
2. Apply “retrofitted label” 1049101 to the outside of the coil door.

**NOTE: After all modifications are complete and verified, reconnect power.**



**10490020**  
(New)