

69-2757ES-01

Cross Reference (Use only as a replacement for these Honeywell pilots)

Old Part #	Set Hood	Use Orifice†	Compression Fitting	Igniter Lead
Q3451B1004	L	Orange Bag	1/4 in.	36 in.
Q3451B1079	F	Purple Bag	1/4 in.	36 in.
Q3451B1095	F	Orange Bag	1/4 in.	36 in.
Q3451B1103	L	Orange Bag	1/4 in.	55 in.
Q3451B1178	L	Orange Bag	1/4 in.	55 in.
Q3451B1186	F	Orange Bag	1/4 in.	55 in.
Q3451B1194	F	Purple Bag	1/4 in.	55 in.
Q3451B1236	L	Gray Bag	1/4 in.	55 in.
Q3451B1244	L	Orange Bag	1/4 in.	55 in.
Q3451B1301	L	As Shipped	1/4 in.	36 in.
Q3451B1707	L	Red Bag	1/4 in.	36 in.
Q3451B1715	L	*	1/4 in.	36 in.
Q3451B2002	F	Orange Bag	1/4 in.	36 in.
Q3451B2010	F	Orange Bag	1/8 in.	36 in.
Q3451B2036	F	Orange Bag	1/4 in.	36 in.
Q3451B2044	F	Orange Bag	1/4 in.	55 in.

Old Part #	Set Hood	Use Orifice†	Compression Fitting	Igniter Lead
Q3451B2077	F	As Shipped	1/4 in.	36 in.
Q3451B2085	F	Gray Bag	1/4 in.	36 in.
Q3451B2101	F	Orange Bag	1/4 in.	55 in.
Q3451B3018	R	Orange Bag	1/4 in.	36 in.
Q3451B3026	R	Orange Bag	1/8 in.	36 in.
Q3451B3067	R	Orange Bag	1/4 in.	36 in.
Q3451B3083	R	Orange Bag	1/4 in.	36 in.
Q3451BF	F	*	*	*
Q3451BK	R	*	*	*
Q3451BL	L	*	*	*
Q3451K2002	F	As Shipped	1/4 in.	55 in.
Q3451K2010	F	Gray Bag	1/4 in.	55 in.
Q3451K2028	F	As Shipped	1/4 in.	55 in.
Q3451KF	F	*	*	*
Q3451U1000	*	*	*	*

Key	Set Hood To	Use Orifice	Igniter Lead
	L = 20° Left F = Front R = 20° Right	As Shipped = BCR-20 (0.020 in.) Natural gas Orange Bag = BCR-18 (0.018 in.) Natural gas Purple Bag = BCR-10 (0.010 in.) LP gas Gray Bag = BBR-12 (0.012 in.) LP gas Red Bag = BBR-11 (0.011 in.) LP gas	36" (As Shipped) 55" (Packed separately)
	†	Colors refer to the color of the label on the bag.	* Check Application

Note

This pilot replaces only Honeywell standard single-rod, hood-style intermittent pilot burners with integral ignition and a sensing wire.

It will not replace batwing style pilot burners or pilot burners without an integral ignition and sensing wire.

- For intermittent pilot, batwing style pilot burners without an integral ignition and sensing wire see the Q348U.
- For intermittent pilot, hood style pilot burners without an integral ignition and sensing wire see the Q345U.
- For standing pilot hood style pilot burners, see the Q314U.

The specifications given here do not include normal manufacturing tolerances. Therefore, this unit may not exactly match the listed specifications.

This product is tested and calibrated under closely controlled conditions, and some minor differences in performance should be expected if those conditions are changed.

WHEN INSTALLING THIS PRODUCT...

- Read these instructions carefully. Failure to follow instructions can damage equipment or cause a hazardous condition.
- Check cross reference in the installation guide or box to verify the pilot is suitable for your application.
- Installer must be a trained, experienced service technician.
- After completing installation, use these instructions to check out product operation.

WARNING

FIRE OR EXPLOSION HAZARD. CAN CAUSE PROPERTY DAMAGE, SEVERE INJURY, OR DEATH.

Follow these warnings exactly:

- Disconnect power supply before wiring to prevent electrical shock or equipment damage.
- To avoid dangerous accumulation of fuel gas, turn off gas supply at appliance service valve before starting installation and perform Gas Leak Test after completion of installation.
- Do not bend pilot tubing within 3 inches of the gas control or pilot burner after compression nut has been tightened. Gas leakage at the connection can result.

Follow the appliance manufacturer instructions, if available; otherwise, use the instructions provided.

1 Remove the Old Pilot Burner

- A** Make sure gas is shut off.
- B** Remove old Pilot Burner, including the old compression fitting.
- C** Match the old model number to the Cross Reference.
- D** Use the information in the Cross Reference to install the Pilot Burner.

2 Set the Hood

See Cross Reference for position.

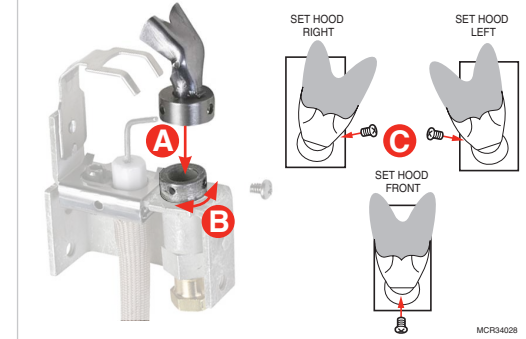

WARNING

FIRE OR EXPLOSION HAZARD. CAN CAUSE PROPERTY DAMAGE, SEVERE INJURY, OR DEATH.

Pilot flame must be positioned in the exact same position with respect to the main burner. The screw must be installed through the pilot hood and into the spud, so the head of the screw is flush with the adapter. Failure to properly orient the pilot flame and/or secure the pilot hood may create an explosion hazard.

3 Mount Pilot Burner

Use the included screws to mount the Pilot Burner.

Position the Pilot Burner so the pilot flame is aimed at the main burner exactly the same way as the original pilot burner flame.

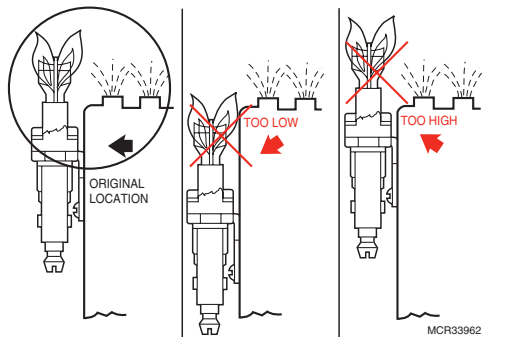

WARNING

FIRE OR EXPLOSION HAZARD. CAN CAUSE PROPERTY DAMAGE, SEVERE INJURY, OR DEATH.

Pilot burner flame alignment to the main burner is critical to safe appliance operation. Carefully read all installation instructions. Replace only those pilots listed in the literature.

4 Install the Correct Orifice and Compression Fitting

See Cross Reference for orifice and sizes.

Cut off the old compression fitting and replace with the new compression fitting provided with the new pilot burner. Never use the old compression fitting because it might not provide a gas-tight seal.

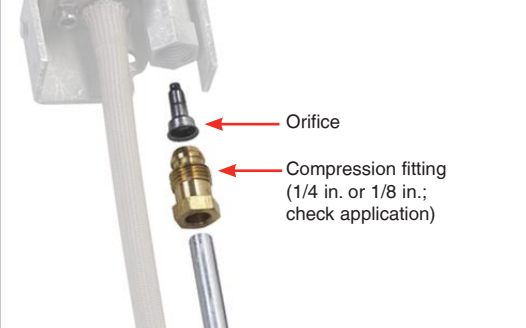

WARNING

FIRE OR EXPLOSION HAZARD. CAN CAUSE PROPERTY DAMAGE, SEVERE INJURY, OR DEATH.

Orifice must be the same size as the original orifice.

5 Connect the Ignition Cable and Ground Wire

The igniter-sensor must be mounted on the pilot burner before connecting the wires.

Use the 36 in. or 55 in. igniter lead as specified in the Cross Reference or as required by the application.

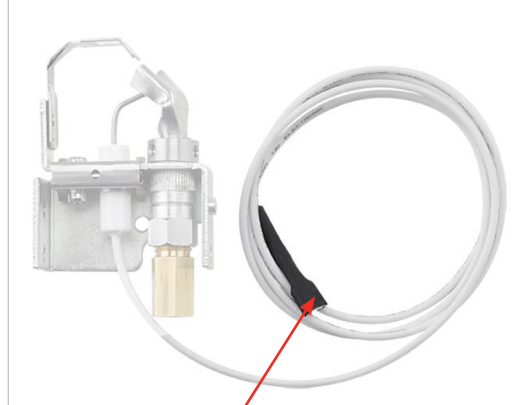

Connect the 1/4-in. quick-connect to the spark terminal of the ignition module.

NOTE: Connect ground wire if present or applicable.

6 Gas Leak Test and Checkout

Gas Leak Test

- A** Make sure warning card has been removed from the pilot.
- B** Turn on gas supply.
- C** Use a gas sniffer* or paint the pipe connections upstream of the pilot burner with a rich soap and water solution to check for leaks. Bubbles indicate a gas leak.
- D** If a leak is detected, tighten the pipe connections.
- E** Stand clear of the main burner while lighting to prevent injury from hidden leaks, which can cause flashback in the appliance vestibule.
- F** Set the thermostat to call for heat to light the main burner.
- G** With the main burner in operation, paint the pipe joints (including the adapters) and gas control inlet and outlet with rich soap and water solution or use a gas sniffer* to check for leaks.
- H** If another leak is detected, tighten the adapter screws, joints, and pipe connections.
- I** Replace the part if the leak cannot be stopped.
- J** Do not proceed until all gas leaks are eliminated.
- * See AHRI video for proper use and considerations when using an electronic gas sniffer

Checkout
Cycle the furnace through several cycles to ensure proper smooth light off.

WARNING

FIRE OR EXPLOSION HAZARD. CAN CAUSE PROPERTY DAMAGE, SEVERE INJURY, OR DEATH.

Check for gas leaks any time work is done on a gas system.

7 Adjust Pilot Flame

The pilot flame should envelop 1/4 to 1/2 in. (6 to 13 mm) of the igniter-sensor tip.

- A** Turn off the system.
- B** Disconnect the lead to the MV terminal on the gas control.
- C** Light the pilot by setting the thermostat above room temperature to call for heat.
- D** Remove the pilot adjustment cover screw from the gas control.
- E** Turn the inner pilot adjustment screw clockwise to decrease or counterclockwise to increase the pilot flame.
- F** Replace the pilot adjustment cover screw and tighten firmly after adjustment is complete to ensure proper operation.

NOTE: If Pilot flame is too small and cannot be adjusted to a larger size, a larger orifice may be needed. Check application requirements. If Pilot flame is too large and cannot be adjusted to a smaller size, a smaller orifice may be needed. Check application requirements

WARNING

FIRE OR EXPLOSION HAZARD. CAN CAUSE PROPERTY DAMAGE, SEVERE INJURY, OR DEATH.

Using the incorrect orifice or pilot hood can cause an unstable pilot, too large or too small of a pilot, pilot outage, reduced pilot life, improper lightoff, or gas buildup.

For additional information and a full-length product data document, scan this QR code or go to www.customer.honeywell.com/universalpilot



Automation and Control Solutions
Honeywell International Inc.
1985 Douglas Drive North
Golden Valley, MN 55422

<http://customer.honeywell.com>

