

### INSTALLATION INSTRUCTIONS

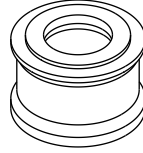

**P21640**

## INSTALLATION INSTRUCTIONS

### THANK YOU FOR CHOOSING KALLISTA

We appreciate your commitment to Kallista quality products. Please take a moment to review this manual before you install your Kallista product. If you encounter any installation or performance problems, please do not hesitate to contact us at the phone number listed at the bottom of the page.

### BEFORE YOU BEGIN

- Observe all local plumbing and building codes.
- Shut off the main water supply.
- The basin and drain shown in this guide may differ from your actual product. The installation steps still apply.
- Kallista reserves the right to make revisions in the design of products without notice, as specified in the Price Book.

### TOOLS AND MATERIALS



Plumbers  
Putty



Adjustable  
Wrench



Strap  
Wrench

### INSTALL THE DRAIN AND DRAIN SPACER

- Remove the cover, stopper and flange from the drain body.
- Install the nut, washer, drain gasket, spacer and gasket onto the drain body.
- Apply plumbers putty to the underside of the flange.
- Assemble the drain onto the basin, completing the drain installation according to the drain manufacturer's instructions.

