

Parts Included



One piece molded RBX



4 adjustable mounting adaptors, 2 attached per end, each includes an optional pin to mark box position in sheetrock.



Extra evaporator bracket, if required support



2 Faceplate Clips



Adaptor

INSTALLATION PROCEDURE - PREPARING THE **RoughinBox™**

1



If using a cable port, select $\frac{1}{2}$ " or $\frac{3}{4}$ " port as required. Use utility knife to cut into the X marked on the top of the port and push cable through opening. This creates an integral strain relief bushing to prevent cable pulling out by itself. **NOTE THAT CABLE CAN ALSO BE BUNDLED WITH LINESET SO THAT IT ENTERS BOX THROUGH THE LINESET PORT.**

2



THIS BOX INCLUDES 5 LINESET PORTS, 1 ON EACH END, 2 ON TOP AND 1 ON THE BOTTOM. FOR TOP OR BOTTOM LINEPORTS: Linesets from evaporator always run from right to left, so, facing front of **RoughinBox™**; always try to bring linesets into box from left to avoid difficulty connecting them to evaporator. Keep lineset entry orifice as small as possible by using the cut lines provided on top of lineport cap to cut away only enough of cap surface to permit entry of lineset then cut along the horizontal cut lines just below the cap. **DO NOT CUT BELOW THIS LINE AS THIS WILL DAMAGE THE SLOT WHICH RETAINS THE MOUNTING ADAPTOR.**

3

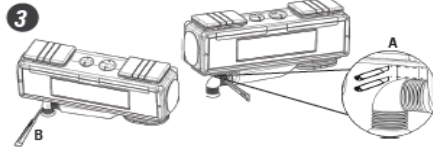

IF USING A CONDENSATE PUMP, DO NOT REMOVE CLOSURE CAP AT END OF DRAIN OUTLET, WHICH MUST REMAIN INTACT. FOR GRAVITY DRAIN - Box has a bi-directional drain outlet with $\frac{3}{4}$ " MIPF threads which provides 2 options: A. FOR SIDE DISCHARGE - Remove reinforcing strut (A) between bottom of sump and top of threads on drain outlet then remove the 90 degree elbow section at end of horizontal thread and thread on a $\frac{3}{4}$ " FIPF to socket coupler (Universal part number 435-007), then attach balance of drain line as required. B. FOR BOTTOM DISCHARGE - Remove reinforcing strut (A) between bottom of sump and top of threads on drain outlet then remove closure cap at end of drain outlet and thread on a $\frac{3}{4}$ " FIPF to socket coupler (Universal part number 435-007) to direct drain line downwards then attach balance of drain line as required. **NOTE: DRAINAGE PIPE IS ATTACHED ONLY AFTER **RoughinBox™** IS INSTALLED. USE OF $\frac{3}{4}$ " RIGID PIPE IS STRONGLY RECOMMENDED. REFER TO STEP 12. TO ENSURE WATERTIGHTNESS, ALWAYS USE PTFE TAPE ON THREADED JOINTS. IF space restrictions mandate use of flexible drain hose, a $\frac{3}{4}$ " FIPF to 5/8" barb adaptor is required. (Part number 33063W). ALWAYS CLAMP ALL FLEXIBLE CONNECTIONS.**

4



Remove all 4 mounting adaptors from slots at both ends of **RoughinBox™**; invert them so the fixing holes on top face up and fixing holes on bottom face down and replace them into the same slot.

5

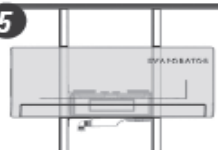

Consult manufacturers installation instructions to determine minimum distance between evaporator and ceiling and mark this dimension on studs. (Normally, recommended minimum dimension between ceiling and baseline, i.e. bottom of faceplate of **RoughinBox™** is 20"). Position **RoughinBox™** to align correctly with evaporator and mark studs accordingly.

6



FOR HORIZONTAL DISCHARGE: Cut on 1 $\frac{1}{2}$ " opening in the stud facing the drain outlet and attach drain line as required. FOR VERTICAL DISCHARGE: Drain outlet faces downwards so no stud cutting is required.

7



If studs are metal, determine which end of **RoughinBox™** will face open side of stud and extend mounting adaptors on that end to their full length of 1 $\frac{1}{8}$ " so that they reach into the stud to touch the flat surface, and lock them into position. IF STUDS ARE WOOD, MOUNTING ADAPTORS WILL NOT NEED TO BE EXTENDED AND THEY CAN BE USED AS IS FOR FIXING.

INSTALLING THE LINESET & CABLE

8

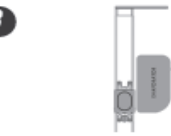

Line up the base of the **RoughinBox™** with the mark on the studs, insert it between the studs, and, using the 4 integral mounting brackets, attach it in place. Rear face of box must be flush with rear stud surface to ensure that front face of box protrudes $\frac{1}{2}$ " from front stud surface. **NOTE: TO ENSURE DRAINAGE, THE BASE LINE OF THE **RoughinBox™** MUST NEVER BE ABOVE THE BOTTOM OF THE EVAPORATOR.**

9



Cut around faceplate only along top and both side edges (lines 1, 2 and 3). BOTTOM EDGE (4) IS ONLY PARTIALLY CUT SO IT CAN FORM A HINGE FOR FACEPLATE TO FOLD DOWN FOR ACCESS TO INTERIOR. CUT INWARDS FROM CORNERS ONLY.

10

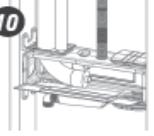

Insert at least 12" of lineset through port selected. Also insert cable but leave 48" slack to ensure it will reach terminal block in evaporator.

11

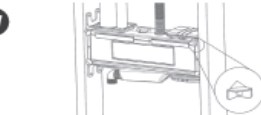

Using the 2 plastic clips provided, close off the aperture by refitting the faceplate which remains in place until the sheetrock and painting are complete. If desired, attach the 4 optional marking pins, (which are attached to the mounting brackets) onto each corner of the front surface of the box to facilitate marking the position of the box prior to installation of sheetrock.

12

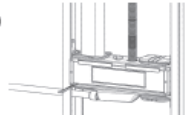

Attach horizontal or vertical drain line as required to drain outlet and connect balance of drainage system, ensuring that drain is completely clear, drain slope is sufficient and all joints are watertight. USE OF $\frac{3}{4}$ " RIGID PIPE IS STRONGLY RECOMMENDED.

INSTALLING THE EVAPORATOR

13

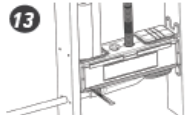

Cut along bottom hinge (line 4) and remove faceplate completely to expose lineset & cable. If using gravity drain, discard faceplate.

14



Determine correct position of evaporator and install metal evaporator mounting bracket onto wall surface. If metal evaporator bracket requires further fixing to wall, insert plastic evaporator bracket support into interior slot at top and bottom of **RoughinBox™**; align with hole on metal mounting bracket as indicated and secure with a screw.

15

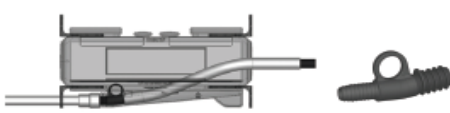

DIRECT CONNECTION BETWEEN EVAPORATOR DRAIN HOSE AND DRAIN OUTLET IN BOX IS THE PREFERRED OPTION AND IS STRONGLY RECOMMENDED. If necessary, remove plastic drain hose nipple and cut drain hose down to length required. Insert 5/8" barb on model RBDA-2 DRAIN ADAPTOR (supplied with box) into cut end of drain hose and secure with clamp. Using WD40 or Vaseline as a lubricant on other end of drain adaptor, insert it into the drain outlet receptacle of the box, ensuring it is securely seated. **NOTE: ALWAYS ENSURE THAT EVAPORATOR DRAIN HOSE HAS A CONTINUOUS DOWNWARD SLOPE TO FACILITATE DRAINAGE.**

16

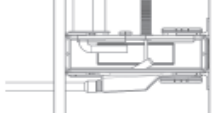

If direct connection is not used, cut evaporator drain hose down to suitable length and insert it loose into sloped drainage sump. **NOTE: ALWAYS ENSURE THAT EVAPORATOR DRAIN HOSE HAS A CONTINUOUS DOWNWARD SLOPE TO FACILITATE DRAINAGE.**

OTHER FEATURES

17

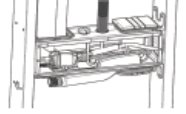

If a pump will be used for condensate removal, faceplate, when detached, will provide a mounting bracket for reservoir and/or pump. Mount reservoir and/or pump onto bracket (faceplate) with screws or Velcro tape and slide it into the internal slots provided along the bottom of rear and front faces of the **RoughinBox™** to lock it into place. Connect & wire pump as per manufacturers instructions.

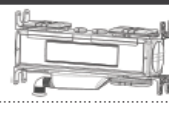

RoughinBox™ RBX-3-MD-NC is fully reversible for LH or RH installation.



If rear access is required for maintenance purposes, rear faceplate can be removed from inside box by cutting along the internal score line and then a corresponding hole can be cut in the sheetrock to provide an opening which can be closed off with a White Finishing Cover RBXCP (available as an accessory).