

Automatic Air Vent - Automatic Air Vent with check valve

5026-5027 Series



Function

Float type automatic air vent designed to vent air that is released from the water while being heated. Check valve on 5027 series allows for easy replacement of air vent without purging the system.

Technical Characteristics

Connection:	1/8" NPT Male
	1/4" NPT Male
Material: Body	Brass
Seals	EPDM
Maximum Working Pressure: Hot Water:	150 psi (10 bar)
Maximum Venting Pressure:	90 psi (6 bar)
Maximum Working Temperature:	240°F (115°C)



SAFETY INSTRUCTION

This safety alert symbol will be used in this manual to draw attention to safety related instructions. When used, the safety alert symbol means **ATTENTION! BECOME ALERT! YOUR SAFETY IS INVOLVED! FAILURE TO FOLLOW THESE INSTRUCTIONS MAY RESULT IN A SAFETY HAZARD.**



CAUTION: All work must be performed by qualified personnel trained in the proper application, installation, and maintenance of systems in accordance with all applicable codes and ordinances.



CAUTION: Over-tightening and breakage can occur with the use of Teflon® pipe joint compounds. Teflon® provides lubricity so that care must be exercised not to over-tighten joints. Failure to follow these instructions could result in property damage and /or personal injury.



WARNING: System fluids are under pressure or temperature can be hazardous. Be sure the pressure has been reduced to zero and the system temperature is below 100°F (38°C). Failure to follow these instructions could result in property damage and/or personal injury.

Installation

The vent is installed in the vertical position, on the air separator, on manifolds, on riser pipes and generally in parts of the system where a concentration of air pockets is to be expected.

Check valve on 5027 series should be installed prior to air vent. Insure air vent is properly lined-up with female check valve guide.

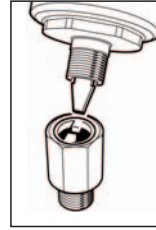

Correct

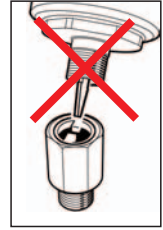

Wrong



CAUTION: Uncontrolled venting of water can occur with the automatic air vent if dirt, scale, pipe joint compound or any other foreign materials becomes trapped in the operating mechanism. Keep vent cap closed during filling to prevent dirt from flowing into vent mechanism. Failure to follow these instructions could result in property damage and/or personal injury.

Operation Instructions

The automatic air vent can be used for manual or automatic venting of sealed hydronic systems.

- For normal automatic venting, open cap one full turn for a slow release of air. A fast release of the air will allow dirt or scale in the water to plug the operating mechanism. The small hole in the side of the cap allows air to escape.
- To shutoff automatic air vent, screw cap down tight.



CAUTION: Corrosion or leakage can cause damage or injury. Periodically inspect for signs of corrosion or leakage. If corrosion or leakage is note, the vent must be replaced. Failure to follow these instructions could result in property damage and/or personal injury.

Service Instructions

There is no service required for the automatic air vent.



Caleffi North America, Inc.
9850 South 54th Street
Milwaukee, WI 53132
T: 414.421.1000 F: 414.421.2878